

# METRO Shower

## INSTALLATION INSTRUCTIONS



Impresa Tile Showers Ltd.

P. 09 273 4545 E. [support@impresa.co.nz](mailto:support@impresa.co.nz)

## SHOWER INSTALLATION



### STEP 1

#### FRAMING

Ensure framing is plumb or no greater than 10mm out of plumb.

Ensure the floor is no greater than 5mm out of level.

Install a row of nogs around tray height to allow fixing for bottom of wet-wall lining. Install nogs as required if a Quik Niche is to be utilised.

#### WASTE-TRAP POSITION / INSTALLATION

The shower tray is to sit 6mm away from the wall framing.

To determine the centre of the tray easy-clean waste-trap, either add 6mm to the measurement of the position of the waste hole in the shower tray and mark onto the bathroom floor or simply place the tray onto the floor 6mm away from the framing.

Connect the waste pipe and waste-trap to the correct lateral positions. The floor is to be no more than 5mm out of level. If the plywood floor is to be made level, ensure the trap height is correct once the floor plywood and tray have been installed. For timber / plywood floor installations, and where access is available under the floor, connect the waste-trap after the tray has been installed.



### STEP 2

#### TILE ADHESIVE TO SHOWER FLOOR AREA AND TRAY

Ensure the shower-area floor surface is free of dirt and dust. Mix tile adhesive to a 'stiff' consistency which allows adhesive to remain stuck on tray foam support pads when tray is lifted to a vertical position at time of placement. Using a 10mm notched trowel, apply tile adhesive to the shower-area floor.

Lay shower tray flat with underside and foam pads facing up. Apply a thin 'primer' amount of tile adhesive to each foam pad on tray underside then apply a minimum 10mm thickness of adhesive to each foam support, adding extra adhesive as required for uneven / unlevel floors.

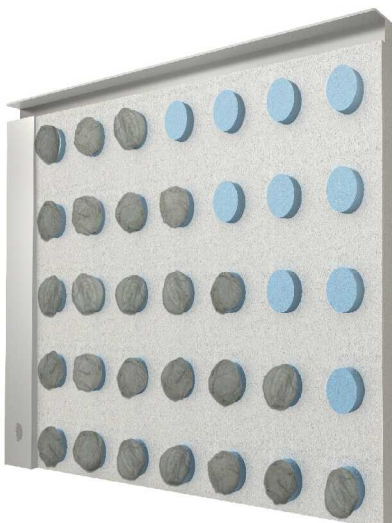

### STEP 3

#### PLACEMENT / INSTALLATION OF TRAY

With adhesive on tray foam pads and shower floor area, gently place shower into the required area. Ensure the tray is level along the 'door side' of the tray and from that point across to the other corner of the tray. Push the tray down or lift the tray up and add extra adhesive as required to make tray level.

Lightly tap-down the entire tray to ensure bonding between the adhesive on the tray and the floor.

**CAUTION: Ensure the tray is level or no greater than 5mm out of level from corner to corner at both walls.**

Do not apply any heavy weights to the tray. Allow 24 hours for adhesive to cure sufficiently before walking on tray. When adhesive is cured, stand and walk on tray to check it is well bonded to floor and is not flexing.

## SHOWER INSTALLATION

### STEP 4

#### WASTE-TRAP / TRAY ALIGNMENT AND INSTALLATION

With waste trap installed at the correct height (see Step 1). Screw the waste chromed threaded flange ring a few rotations into the trap body. Apply silicone sealant to the underside of the chromed flange and fully tighten onto the tray. Alternatively, where possible, attach the waste-trap to the tray and outlet pipe after installation of the tray. See waste trap schematic drawing included with Installation literature.

#### FRAME / TRAY PERIMETER NOGGING

If not done prior, install a row of nogs to framing at tray height to allow fixing of bottom edge of wet-wall lining.

#### QUIK NICHE FRAMING

If a Quik Niche is to be utilised, install the required framing to accommodate the perimeter of the niche.



### STEP 5

#### CHECK TRAY ADHESION TO FLOOR

*To ensure the tray is well-bonded to the floor, stand and move about on the tray, checking for flexing / movement of the tray. If there is any movement, lift the tray and re-adhere.*

#### QUIK NICHE INSTALLATION

If required, install Quik Niche as per Impresa instructions supplied with niche.

#### WALLBOARD INSTALLATION

Before affixing wallboard, ensure the shower wall framing is plumb or not more than 10mm out of plumb -- pack wall to suit if required.

Cut and affix wet-area wallboard to framing as per manufacturer's instructions.

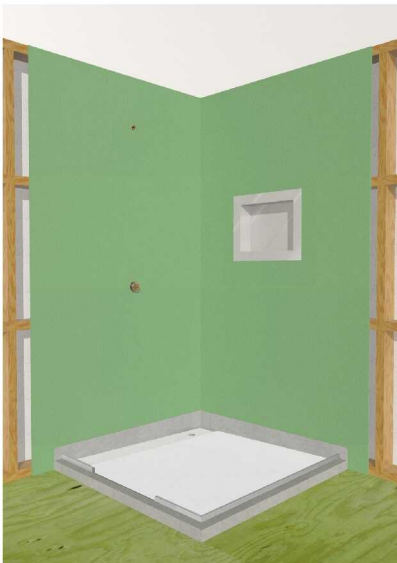

### STEP 6

#### PRE-WATERPROOFING CHECK

Prior to application of the waterproofing membrane, ensure the shower walls are plumb or no more than 10mm out of plumb.

*CAUTION: Tiler or waterproofer should check the tray is solidly-bonded to the floor and is not flexing BEFORE proceeding with the application of a waterproofing membrane.*

#### JOINT TAPE AND WATERPROOFING MEMBRANE APPLICATION

In accordance with the manufacturer's specifications and instructions, apply a primer to the shower wall linings and bathroom floor.

Apply a peel and stick butyl tape to span the tray side-upstand / wall lining joints, and a further butyl tape to the tray front threshold or flange and onto the bathroom floor. Brush or roll a liquid waterproofing membrane to the shower walls and down across the applied butyl tape and onto the tray sides. Apply the liquid waterproofing to the bathroom floor and onto the butyl tape applied to the tray front threshold or flange.

For sheet membranes, refer to the manufacturer's instructions.

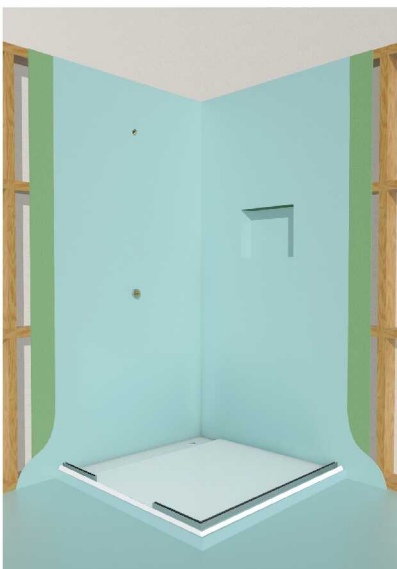



## SHOWER INSTALLATION

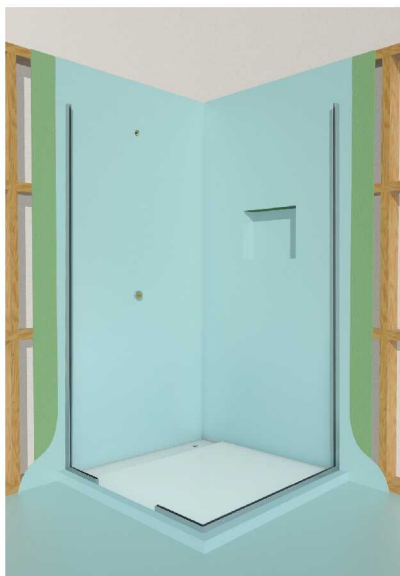

### STEP 7

#### WALL GLAZING CHANNEL INSTALLATION

*CAUTION: Tiler -- BEFORE tile is applied, wall glazing channels MUST be adhered to the waterproofed walls.*

Place an 1800mm-long spirit level against the inside face of tray glazing channel and mark the 'plumb' position on the wall. Repeat procedure on other wall.

**Standard Wall Channel Height** -- Both supplied wall channels are pre-cut at 1965mm. Ensure the wall channel that receives the glass 'Hinge Panel' (panel that door hinges attach to) is installed at the supplied length of 1965mm. Trim the second wall channel length / height if necessary to ensure the channel is level with the corresponding Hinge Panel channel. Apply a bead of supplied silicone sealant- adhesive to the bottom side of both pre-cut wall glazing channels and adhere each to the wall at the pre-marked plumb position. Apply a second and third bead to the inside and outside channel / wall junctions. Do a final check to ensure each channel is plumb and level with the other at the top.

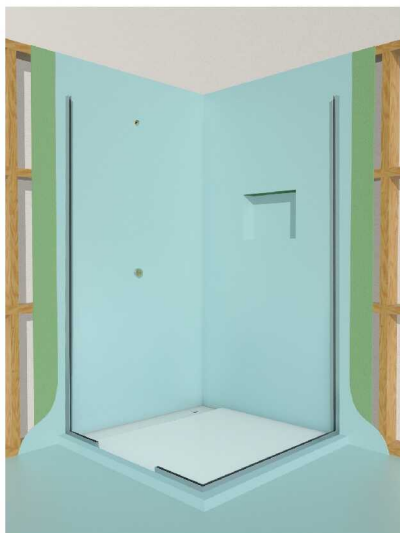

### STEP 8

#### TILE APPLICATION

*The tiler should check the tray has been well-bonded to the floor and is not flexing BEFORE proceeding with tile installation.*

Adhere tile to the tray with Mapei 'Kerapoxy Adhesive' or Sika 'Sikadur-32 Normal' as per the manufacturer's instructions

Apply tile adhesive to the tray main standing area ensuring the height of the tile finishes flush or 1-2mm above the channel cover / grate height when in-situ. Ensure the tile extends 1-5mm past the leading-edge of the drainage channel so that the edge of the tray is not visible. **Do NOT apply tile to the channel drain area – the channel drain area is to be left as supplied (exposed white coating) for the ease of cleaning when shower is in-use.**

All tiling should comply with BRANZ recommendations, industry standards, and the tile adhesive manufacturer's specifications.



### STEP 9

#### PLUMBING FIXTURES INSTALLATION

Install plumbing fixtures to shower.

### STEP 10

#### GLASS INSTALLATION

Impresa recommends the installation of the frameless-glass enclosure be performed by an experienced frameless-glass installer.

See Glazing Installation Overview – click the 'Technical / Drawings' button on the METRO page – [www.impresa.co.nz](http://www.impresa.co.nz).

# METRO

## EASY CLEAN WASTE TRAP (ECW4040) SPECIFICATIONS AND INSTALLATION

### EASY-CLEAN WASTE TRAP SCHEMATIC

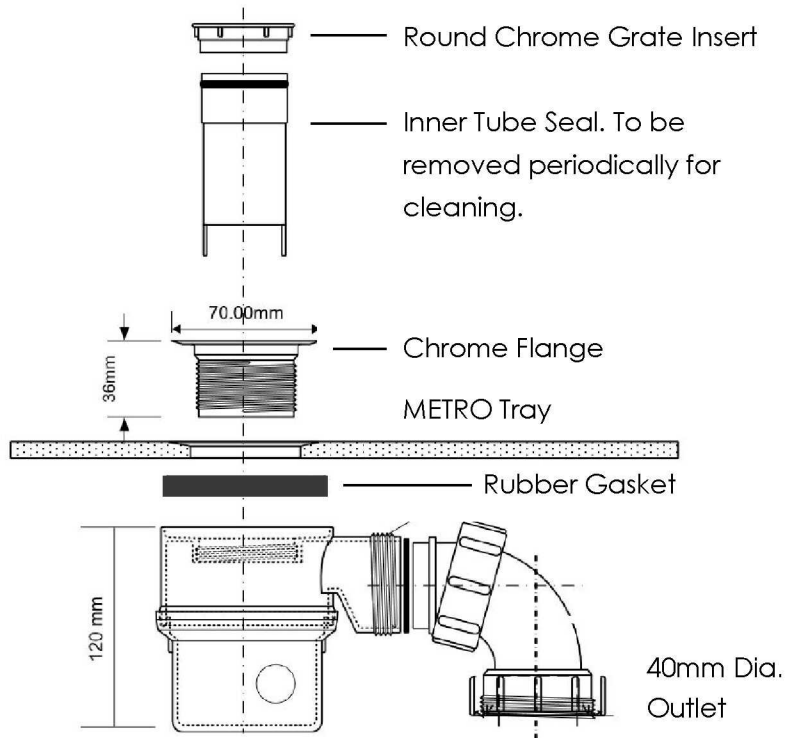

### EASY-CLEAN TRAP OPTION

Flow Rate: 21 litres / min  
Water Seal: 50mm Inner Tube/Seal Ring  
Inlet Size Dia: 40mm / Outlet Size Dia: 40mm  
Body Overall Depth: 120mm  
DWV pipe compliant with AS/NZS1260

**INSTALLATION** -- Neutral-cure silicone is to be applied to the bottom side of the Chrome Flange and threaded into the easy-clean body and tightened down onto the shower tray.

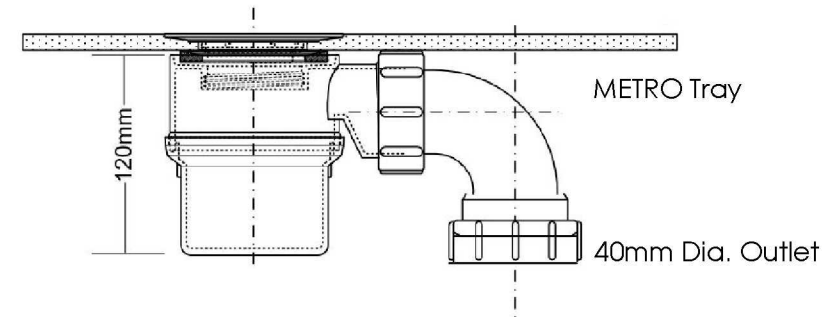

### WASTE FITTING OPTION

Removal of the Inner Tube-Seal creates a waste-fitting to which a 40mm, 50mm diameter or larger outlet pipe can be connected. A P-Trap or S-Trap must be connected to the waste fitting to prevent the egress of sewer gases.

# SHOWER TRAY INSTALLATION ADHESIVES.

## TRAY TILE APPLICATION ADHESIVES.

### TRAY INSTALLATION TO FLOOR

Apply one of the recommended thinset tile adhesives below to a minimum 10mm-thickness to each of the high-density foam pads on the bottom of the tray, AND to the shower area floor with a 10mm notched-trowel.

### RECOMMENDED TILE ADHESIVES

(A) Ardex NZ -- **ARDEX X77**

(B) Australasian Tiling Adhesives -- **AUSFLEX GOLD**

(C) Construction Chemicals NZ -- **DURAFLEX**

(D) ASA Bostik NZ -- **CONFLEX**

(E) Laticrete -- **LATAFLEX GOLD**

(F) Cemix Products -- **RUBBERFLEX**

(G) Davco -- **ULTRAFLEX**

---

### TILE APPLICATION TO SHOWER TRAY (DIRECT-STICK EPOXY ADHESIVE METHOD )

Impresa tileable aluminium shower trays are supplied with a white epoxy coating. All ceramic and porcelain tile is to be adhered directly to the tray with one of the following epoxy adhesives --

Mapei NZ -- **Kerapoxy Adhesive** (epoxy adhesive). For 10mm-thick tile use with 8mm or 10mm trowel.

Sika NZ -- **Sikadur-32 Normal** (epoxy adhesive). For 10mm-thick tile use with 8mm or 10mm trowel.

For smaller and / or thinner tile, use an appropriate smaller-depth trowel size.

### TILE APPLICATION TO SHOWER TRAY (PRIMER / WATERPROOF MEMBRANE / TILE ADHESIVE METHOD)

Tiler is to check with the preferred tile adhesive manufacturer / supplier for the following --

1. Recommended primer onto an epoxy-coated shower tray
2. Recommended waterproof membrane for application onto the applied primer
3. Recommended tile adhesive for shower floors

---

### NOTE

All on-site specifications and conditions are to comply with the respective adhesive manufacturer's specifications and recommendations. Impresa Showers does not imply nor provide any warranties for any tile adhesive listed herein.

---

Impresa Showers

Ph: 09 273 4545 support@impresa.co.nz

**NOTE:** METRO shower trays are one-piece, epoxy-coated aluminium. DO NOT apply liquid waterproofing membrane directly to the tray.

## TRAY / WALL JOINTS & TRAY / FLOOR JOINTS OVERVIEW

Ensure the tray and side-upstands are clean. In accordance with the manufacturer's specifications / instructions, apply a primer 100mm min. up from the bottom edge of the shower wall linings, and a 100mm min. onto the bathroom floor area surrounding the front of the shower tray. DO NOT apply any primer onto the shower tray. Apply a peel and stick, fleece / mesh-lined butyl tape to span all shower tray side-upstand / wall lining joints. Apply a butyl tape to the tray front threshold (or flange, if part of tray design and tray is to be rebated into the floor) and onto the bathroom floor. Apply a liquid waterproofing membrane to the shower walls, across the applied butyl tape and onto the tray side-upstands. Similarly, apply the waterproofing to the bathroom floor and lap onto the tray-front threshold or flange. DO NOT apply waterproofing to the tray internal standing area. Refer to the waterproofing manufacturer's literature for specific instructions and for sheet membrane application. See 'On-Floor' or 'Level-Entry Floor' tray installation drawings on website.

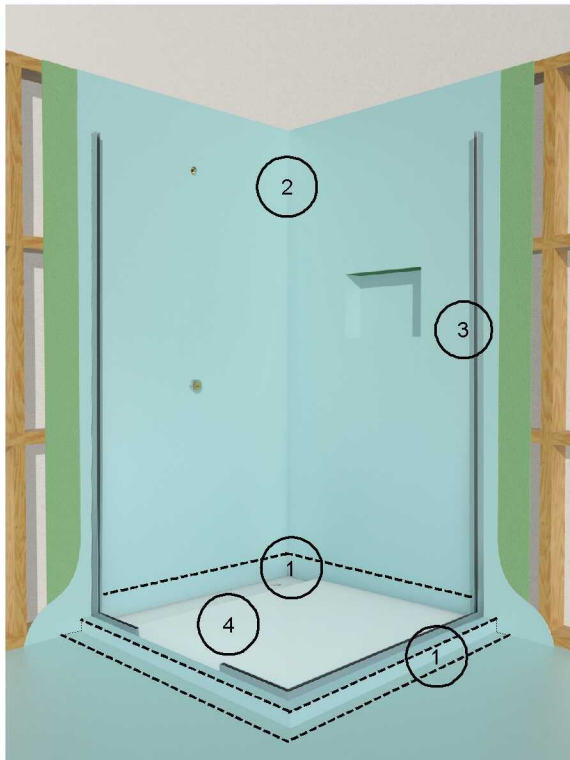

## WATERPROOFING APPLICATION OVERVIEW

**CAUTION:** Before applying waterproofing to the shower walls, walk or jump on the tray to check the tray does not flex. If there is movement, the tray must be lifted and re-adhered correctly.

1. Fleece/mesh-lined butyl tape applied to the tray side-upstand / wall linings joint, and the tray threshold / bathroom floor joint before the application of a waterproofing membrane.
2. Selected cementitious, acrylic or polyurethane waterproofing membrane applied to shower wall linings and onto the butyl tape / tray side upstands.
3. Wall Glazing-channels installed directly to the cured waterproofing.
4. METRO shower tray. DO NOT apply waterproofing to the tray flat, standing area. Ensure the tray is kept covered and clean.

## WATERPROOFING MANUFACTURERS / SUPPLIERS

### MANUFACTURER / SUPPLIER

Sika NZ  
 Ardex NZ  
 Bostick (NZ)  
 Construction Chemicals NZ  
 Construction Technologies  
 Davco  
 Flexco NZ  
 Mapei NZ  
 Technokolla (Protective Surfaces)  
 Waterproofing Systems

### CEMENTITIOUS MEMBRANES

Sikalastic-152  
 Superflex WPM002  
 DampFix 3  
 Liquid Flash 2  
 AquaBlok 2  
 Dampfast  
 Miracryl  
 Mapelastik Smart  
 Rasolastik  
 Gripset 2P

### ACRYLIC / URETHANE MEMBRANES

Sikalastic-220W  
 WPM155 Rapid  
 DampFix Gold  
 Hydrathane  
 AquaBlok W1  
 Dampflex  
 Flexi-Seal  
 Aquadefense  
 Rasogum  
 Gripset 38

## NOTE

All on-site specifications and conditions are to comply with the respective waterproofing manufacturer's specifications and recommendations. Impresa Tile Showers Ltd. does not imply nor provide any warranties for any product listed herein.



# STILE & METRO SHOWER -- ALCOVE

## INLINE GLASS ENCLOSURE INSTALLATION

### IMPORTANT NOTE

**HINGE PANEL** -- to be installed with the top hinge notch beginning 250mm from top edge of panel. Bottom hinge notch is 270mm from bottom edge of panel.

With plumb walls, glass will sit approx. 10-15mm into channel.

**GLASS HINGE PANEL** is to be made plumb and made level with top of glazing channel. Internally, a continuous bead of clear silicone is to be applied between sidelite and channel. Glass panel is to be pushed hard against channel and excess silicone removed. Externally, silicone is to be applied between glass and glazing channel and excess silicone removed. Ensure the installed panel is flush with the end of the tray glazing channel.

Clear silicone applied into each tray / wall channel butt-joint immediately prior to installation of each sidelite.

Apply silicone to open end of channel / bottom of glass sidelite to prevent water ingress into channel.

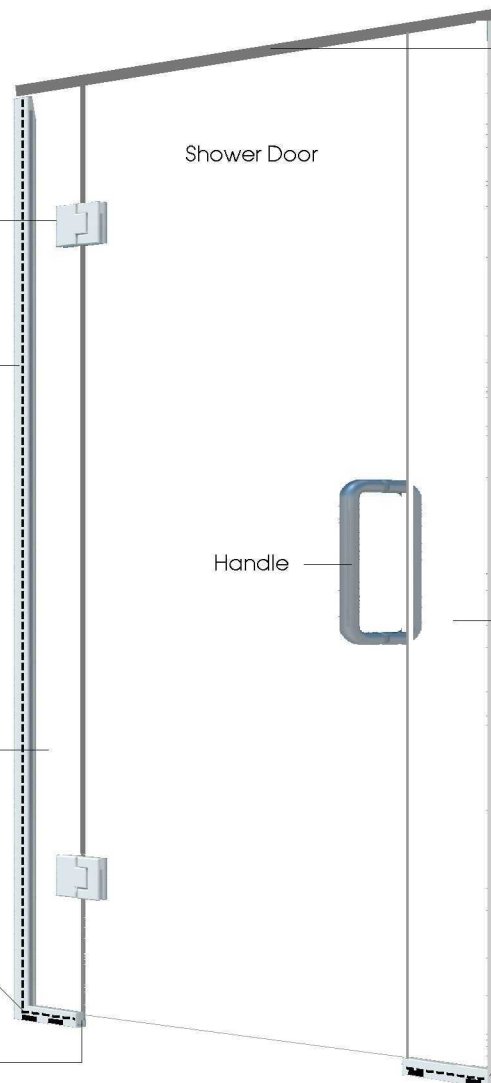

### ALUMINIUM BRACE BAR

Secured with silicone adhesive or Clamp Brackets.

### IMPORTANT NOTE

#### WALL GLAZING CHANNELS

Wall channels are to be adhered directly to the waterproofed walls with the supplied silicone BEFORE the application of wall tile.

Apply a continuous bead of silicone to entire length of back side of channel. Adhere channel to wall and apply a continuous beads of silicone to inside and outside of channel / wallboard junction.

**GLASS SIDE PANEL** -- Install setting blocks into the tray channel and ensure the Side Panel top edge is flush with the wall channel and the Hinge Panel. Place the panel into the tray and wall channels. On the shower internal side, apply silicone between the wall channel and glass panel. Press the Side Panel hard against the channel. Spray water mixture and remove all excess silicone.

**SETTING BLOCKS** -- Use 9x10mm blocks under bottom edge of glass panels to ensure panels are level with top of wall channels or 1.5mm max. above.



# STILE & METRO SHOWER

## CORNER GLASS ENCLOSURE INSTALLATION

### IMPORTANT NOTE

#### WALL GLAZING CHANNELS

Wall channels are to be adhered directly to the waterproofed walls with the supplied silicone BEFORE the application of wall tile.

**GLASS RETURN PANEL** -- is to be made plumb and level with top of glazing channel and Hinge Panel. Internally, apply a continuous bead of clear silicone between glass and glazing channel. Return is to be pushed hard against channel and excess silicone removed. Externally, silicone is to be applied between glass and glazing channel and excess silicone removed.

**GLASS SIDE PANEL** -- Install setting blocks into the tray channel and ensure the Side Panel top edge is flush with the Return Panel. Apply a continuous bead of clear silicone approx. 5mm thick to the Return Panel edge. Insert the Side Panel into the tray channel and press / adhere the Side Panel to the Return panel edge leaving a 2mm silicone joint between both panels. Spray water mixture and remove all excess silicone.

Clear silicone applied to each tray / wall channel butt-joint immediately prior to installation of sidelite or return panel.

Apply clear silicone to bottom of side panels to seal-off end of channels.

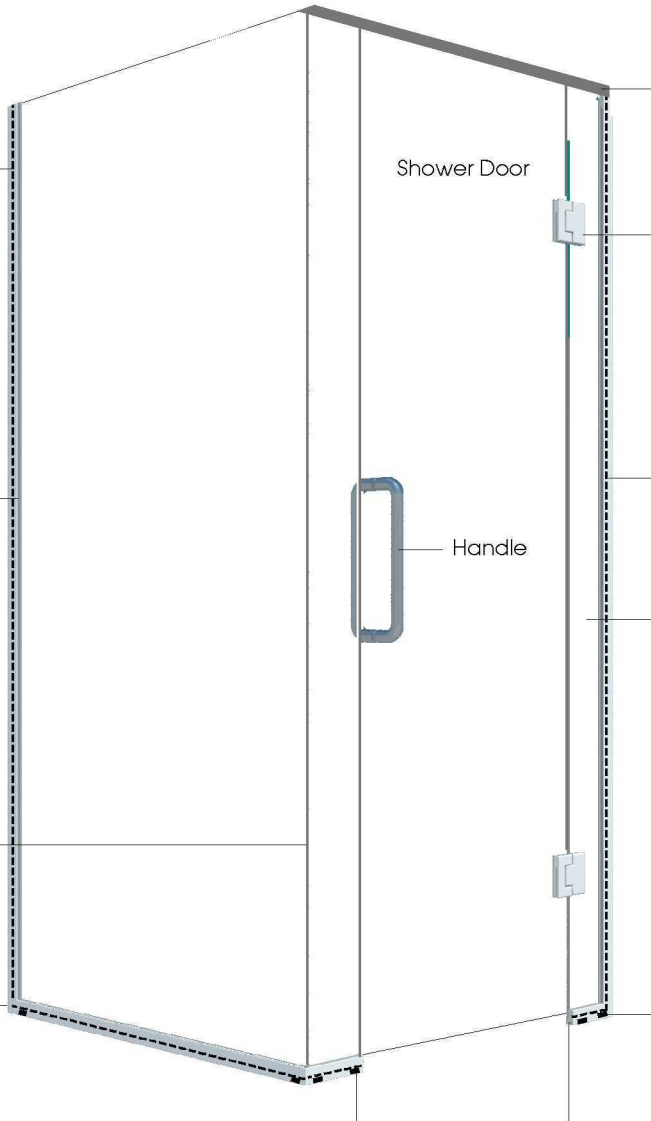

#### ALUMINIUM BRACE BAR

Secured with silicone adhesive or Clamp Brackets.

### IMPORTANT NOTE:

**HINGE PANEL** -- to be installed with the top hinge notch 250mm from top edge of panel. Bottom hinge cut-out is 270mm from bottom edge of panel.

With plumb walls, glass will sit approx. 10 - 15mm into channel.

**GLASS HINGE PANEL** is to be made plumb and made level with top of glazing channel. Internally, a continuous bead of clear silicone is to be applied between sidelite and channel. Glass panel is to be pushed hard against channel and excess silicone removed. Externally, silicone is to be applied between glass and glazing channel and excess silicone removed. Ensure the installed panel is flush with the end of the tray glazing channel.

**SETTING BLOCKS** -- Use 9 x 10mm blocks under bottom edge of glass panels to ensure panels are level with top of wall channels or 1.5mm max. above.