

# IMPRESA TILE SHOWERS

## RECOMMENDED ADHESIVES TRAY INSTALLATION AND TILE APPLICATION

### TILE ADHESIVES FOR INSTALLATION OF SHOWER TRAYS

- |   |                                       |
|---|---------------------------------------|
| (A) Ardex NZ -- ARDEX X77                         | (D) ASA Bostik NZ -- CONFLEX          |
| (B) Australasian Tiling Adhesives -- AUSFLEX GOLD | (E) Cemix Products Ltd. -- RUBBERFLEX |
| (C) Construction Chemicals NZ -- DURAFLEX         | (F) Davco -- ULTRAFLEX                |

#### TRAY ADHESIVE APPLICATION

- (1) The recommended thinset tile adhesive is to be applied onto shower-area floor with a 10mm notched trowel.
- (2) Apply a minimum 10mm-thickness of thinset tile adhesive to each of the high-density foam pads on the bottom of the tray.

---

### CEMENTITIOUS TILE ADHESIVES FOR TILE APPLICATION TO TRAY WITH TILING MEMBRANE APPLIED

**NOTE:** If the tray has been received with the Tiling Membrane either factory-applied or yet to be applied on-site, the membrane must receive two (2) coats of a liquid-applied waterproofing membrane before the application of tile. The coating protects the membrane from dust, and wear and tear, and also performs as a primer for the thinset tile adhesive -- see the list of recommended liquid-applied waterproofing membranes. The thinset tile adhesive for applying tile to the tray should be from the same manufacturer and / or compatible with the liquid-applied membrane.

- |   |  |
|---|--|
| (A) Ardex NZ -- ARDEX77, OPTIMA                     | (F) Davco -- ULTRAFLEX   |
| (B) ASA Bostick NZ -- CONFLEX, MEGAFIX              | (G) Flexco NZ -- FLEXI WALL AND FLOOR                            |
| (C) Australasian Tiling Adhesives -- AUSCRETE GOLD  | (H) Mapei NZ -- KERAFLEX MAXI, KERABOND AND ISOLASTIC            |
| (D) Cemix -- RUBBERFLEX                             | (I) Technokolla / Protective Surfaces -- TECHNO ONE, TECHNO STAR |
| (E) Construction Chemicals NZ -- DURAFLEX, MONOFLEX |  |

### SYNTHETIC TILE ADHESIVES FOR TILE APPLICATION DIRECT TO EPOXY-COATED TRAY

**NOTE:** Where the shower tray has been supplied 'bare' without the tiling membrane factory-applied, the use of a synthetic adhesive is necessary for tile application to the 'white' epoxy-coated tray. The following adhesives are recommended --

- (A) Mapei NZ -- KERALASTIC URETHANE or KERAPOXY
- (B) Sika NZ -- FOSROC FLORBOND 406

---

#### NOTE

All on-site specifications and conditions are to comply with the respective adhesive manufacturer's specifications and recommendations. Impresa Tile Showers Ltd. does not imply nor provide any warranties for any tile adhesive listed herein.

METRO shower trays are supplied with a tray side-upstand membrane tape factory-applied. The wet-area wallboard is to be installed to the shower walls, finishing at the top of, and flush with, the tray side-upstands. A recommended waterproofing membrane is to be applied to the shower walls, down onto the tray side-upstands, and onto the peel and stick tiling sheet membrane if being utilised. NOTE: The wall glazing channels are to be adhered directly to the waterproofed walls PRIOR to the application of wall tile.

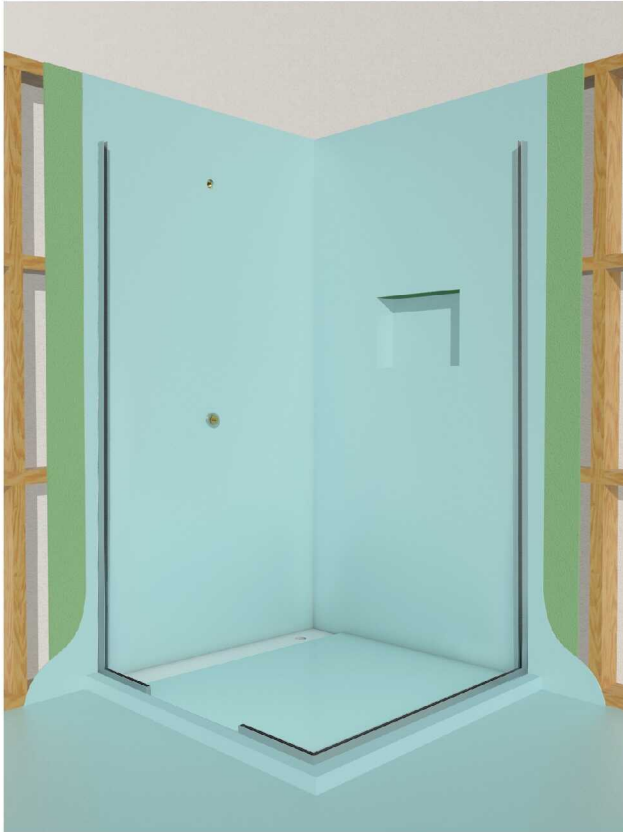

## WATERPROOFING APPLICATION OVERVIEW

NOTE: Ensure tray has been correctly installed and is not flexing with the weight of a person walking / standing

1. Selected cementitious or acrylic waterproofing membrane from list below applied to shower wall linings
2. Wall Glazing-channels installed directly to cured waterproofing
3. METRO shower tray with tiling membrane coated / primed with selected waterproofing.  
Corner waste-outlet trays -- do NOT apply waterproofing to white epoxy-coated channel-drain area.
4. Ensure waterproofing is fully hard-cured before applying tiles.

## WATERPROOFING MANUFACTURERS / SUPPLIERS

MANUFACTURER / SUPPLIER	CEMENTITIOUS MEMBRANES	ACRYLIC / URETHANE MEMBRANES
Ardex NZ	Superflex WPM002	Superflex WPM001
Bostick (NZ)	DampFix 3	DampFix Gold
Construction Chemicals NZ	Liquid Flash 2	Hydrathane
Construction Technologies	AquaBlok 2	AquaBlok W1
Davco	Dampfast	Dampflex
Flexco NZ	Miracryl	Flexi-Seal
Mapei NZ	Mapelastik Smart	Aquadefense
Technokolla (Protective Surfaces)	Rasolastik	Rasogum
Waterproofing Systems	Gripset 2P	Gripset 38

### NOTE

All on-site specifications and conditions are to comply with the respective waterproofing manufacturer's specifications and recommendations. Impresa Tile Showers Ltd. does not imply nor provide any warranties for any product listed herein.