

SHOWER INSTALLATION

STEP 1

FRAMING

Ensure framing is plumb or no greater than 10mm out of plumb.

Ensure the floor is no greater than 5mm out of level.

Install a row of nogs around tray height to allow fixing for bottom of wet-wall lining.

Install nogs as required if a Quik Niche is to be utilised.



WASTE-TRAP POSITION / INSTALLATION

Determine easy-clean waste-trap position by placing the shower tray onto the floor 7mm off the bottom plate / framing. Mark the perimeter of the waste hole on the floor and cut a hole in the floor to position the easy-clean waste-trap. Connect the waste-trap to the waste outlet pipe, ensuring the easy-clean waste-trap is level with the floor. Alternatively, if an option, for timber / plywood mid-floor installations, connect the waste-trap to the tray and outlet pipe from under the floor below the tray.

STEP 2

TILE ADHESIVE APPLIED TO SHOWER FLOOR AND TRAY

Ensure the shower-area floor surface is free of dirt and dust. Mix tile adhesive to a 'stiff' consistency which allows adhesive to remain stuck on tray foam support pads when tray is lifted to a vertical position at time of placement. Using a 10mm notched trowel, apply tile adhesive to the shower-area floor.



Lay shower tray flat with underside and foam pads facing up. Apply a thin 'primer' amount of tile adhesive to each foam pad on tray underside then apply a minimum 10mm thickness of adhesive to each foam support, adding extra adhesive as required for uneven / unlevel floors.

STEP 3

PLACEMENT / INSTALLATION OF TRAY

With adhesive on tray foam pads and shower floor area, gently place shower into the required area. Ensure the tray is level along the 'door side' of the tray and from that point across to the other corner of the tray. Push the tray down or lift the tray up and add extra adhesive as required to make tray level.

Lightly tap-down the entire tray to ensure bonding between the adhesive on the tray and the floor. Check the tray is level or no greater than 3mm out of level.

Allow 24 hours for curing. Stand and move about on tray to check it is well bonded to floor and is not flexing.

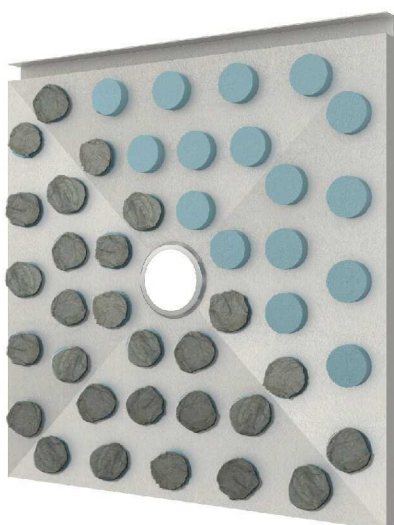

SHOWER INSTALLATION

STEP 4

WASTE-TRAP / TRAY ALIGNMENT AND INSTALLATION

With waste-trap bottom 'O' ring on the waste body, ensure the waste-trap and tray hole-outlet align and that the 'O' ring on the waste body is touching the bottom of the tray outlet hole. Screw the waste top chrome ring a few rotations into the trap body. Apply silicone to underside of waste screw-ring and fully tighten the screw-ring to tray. Alternatively, if possible, attach the waste-trap to the tray from underneath the bathroom floor.

If not done prior, install a row of nogs to framing at tray height to allow fixing of bottom edge of wet-wall lining.



STEP 5

CHECK TRAY ADHESION TO FLOOR

To ensure the tray is well-bonded to the floor, stand and move about on the tray, checking for flexing / movement of the tray. If there is any movement, lift the tray and re-adhere.

QUICK NICHE INSTALLATION

If required, install Quik Niche as per Impresa instructions supplied with niche.

WALLBOARD INSTALLATION

Before affixing wallboard, ensure the shower wall framing is plumb or not more than 10mm out of plumb -- pack wall to suit if required.

Cut and affix wet-area wallboard to framing as per manufacturer's instructions.



STEP 6

WATERPROOFING APPLICATION

Prior to application of waterproofing membrane, ensure the shower walls are plumb or not more than 5mm out of plumb.

Before walking and working on the stainless steel tray, prevent it from being scratched by ensuring it is clean, free of dust, debris, nails, screws, etc., and protected with a thick, soft blanket or fabric cover.

Apply waterproofing to shower walls and bathroom floor as per manufacturer's instructions. Allow the membrane to fully cure before proceeding with channel installation.

STEP 7

WET-WALL PANEL INSTALLATION

For showers which are to have walls finished with Hardiglaze / Seratone / Aquapanel / acrylic liner or similar wet-wall panel lining approx. 3-6mm thickness: Allow waterproofing to cure and adhere the wet-wall panels with a solvent-free / product-compatible adhesive.





STEP 8

WALL GLAZING CHANNEL INSTALLATION

Showers which are to have walls finished with tile, the wall glazing channels are to be adhered directly to the waterproofed walls with the supplied silicone adhesive **BEFORE** the wall tile is applied.

Showers which are to have walls finished with Hardiglaze / Seratone / Aquapanel / acrylic liner or similar wet-wall panel lining approx. 3-6mm thickness -- adhere the wall glazing channels to the installed wet-wall panels with the supplied silicone adhesive.

Place a spirit level against the inside face of tray glazing channel and mark the 'plumb' position on the wall. Repeat procedure on other wall. Ensure the wall channel that receives the 'Hinge panel' (panel to which door hinges attach to) is cut to 1970mm. Second wall channel to be installed to same level as the top of the 'Hinge panel' wall channel. Apply a bead of supplied silicone adhesive to bottom side of pre-cut wall glazing channels, and adhere each channel to the wall at the pre-marked plumb position. Apply bead of silicone to the inside and outside channel / wall junctions. Check wall channels are both level with each other at the top, and plumb 'left-to-right'.



STEP 9

TILE APPLICATION

Apply tile to shower walls as per BRANZ recommendations, industry standards, and tile adhesive manufacturer's specifications.

STEP 10

PLUMBING FIXTURES INSTALLATION

Install plumbing fixtures to shower.

STEP 11

GLASS INSTALLATION

Impresa recommends the installation of the frameless-glass enclosure be performed by an experienced frameless-glass installer. See Glazing Overview at www.impresa.co.nz.

IMPRESA TILE SHOWERS

RECOMMENDED ADHESIVES TRAY INSTALLATION AND TILE APPLICATION

TILE ADHESIVES FOR INSTALLATION OF SHOWER TRAYS

- | | |
|---|---------------------------------------|
| (A) Ardex NZ -- ARDEX X77 | (D) ASA Bostik NZ -- CONFLEX |
| (B) Australasian Tiling Adhesives -- AUSFLEX GOLD | (E) Cemix Products Ltd. -- RUBBERFLEX |
| (C) Construction Chemicals NZ -- DURAFLEX | (F) Davco -- ULTRAFLEX |

TRAY ADHESIVE APPLICATION

- (1) The recommended thinset tile adhesive is to be applied onto shower-area floor with a 10mm notched trowel.
- (2) Apply a minimum 10mm-thickness of thinset tile adhesive to each of the high-density foam pads on the bottom of the tray.

CEMENTITIOUS TILE ADHESIVES FOR TILE APPLICATION TO TRAY WITH TILING MEMBRANE APPLIED

NOTE: If the tray has been received with the Tiling Membrane either factory-applied or yet to be applied on-site, the membrane must receive two (2) coats of a liquid-applied waterproofing membrane before the application of tile. The coating protects the membrane from dust, and wear and tear, and also performs as a primer for the thinset tile adhesive -- see the list of recommended liquid-applied waterproofing membranes. The thinset tile adhesive for applying tile to the tray should be from the same manufacturer and / or compatible with the liquid-applied membrane.

- | | |
|---|--|
| (A) Ardex NZ -- ARDEX77, OPTIMA | (F) Davco -- ULTRAFLEX |
| (B) ASA Bostick NZ -- CONFLEX, MEGAFIX | (G) Flexco NZ -- FLEXI WALL AND FLOOR |
| (C) Australasian Tiling Adhesives -- AUSCRETE GOLD | (H) Mapei NZ -- KERAFLEX MAXI, KERABOND AND ISOLASTIC |
| (D) Cemix -- RUBBERFLEX | (I) Technokolla / Protective Surfaces -- TECHNO ONE, TECHNO STAR |
| (E) Construction Chemicals NZ -- DURAFLEX, MONOFLEX | |

SYNTHETIC TILE ADHESIVES FOR TILE APPLICATION DIRECT TO EPOXY-COATED TRAY

NOTE: Where the shower tray has been supplied 'bare' without the tiling membrane factory-applied, the use of a synthetic adhesive is necessary for tile application to the 'white' epoxy-coated tray. The following adhesives are recommended --

- (A) Mapei NZ -- KERALASTIC URETHANE or KERAPOXY
- (B) Sika NZ -- FOSROC FLORBOND 406

NOTE

All on-site specifications and conditions are to comply with the respective adhesive manufacturer's specifications and recommendations. Impresa Tile Showers Ltd. does not imply nor provide any warranties for any tile adhesive listed herein.

STILE Stainless shower trays are supplied with a tray side membrane tape factory-applied. The wet-area wallboard is to be installed to the shower walls, finishing at the top of, and flush with, the tray side-upstands. A recommended waterproofing membrane is to be applied to the shower walls and down onto the tray side-upstands.

NOTE: The wall glazing channels are to be adhered directly to the waterproofed walls PRIOR to the application of wall tile.

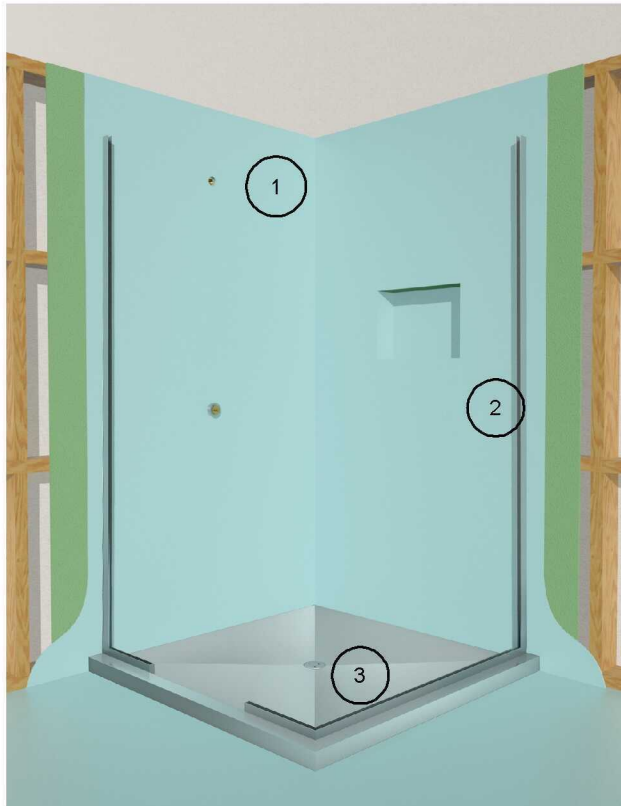

WATERPROOFING APPLICATION OVERVIEW

NOTE: Ensure tray has been correctly installed and is not flexing with the weight of a person walking / standing

1. Selected cementitious or acrylic waterproofing membrane from list below applied to shower wall linings
2. Wall Glazing-channels installed directly to cured waterproofing
3. Stile Stainless shower tray

Waterproofing to be applied to shower as per manufacturer's specifications. Ensure waterproofing is fully hard-cured before applying tiles.

WATERPROOFING MANUFACTURERS / SUPPLIERS

MANUFACTURER / SUPPLIER	CEMENTITIOUS MEMBRANES	ACRYLIC / URETHANE MEMBRANES
Ardex NZ	Superflex WPM002	Superflex WPM001
Bostick (NZ)	DampFix 3	DampFix Gold
Construction Chemicals NZ	Liquid Flash 2	Hydrathane
Construction Technologies	AquaBlok 2	AquaBlok W1
Davco	Dampfast	Dampflex
Flexco NZ	Miracryl	Flexi-Seal
Mapei NZ	Mapelastic Smart	Aquadefense
Technokolla (Protective Surfaces)	Rasolastik	Rasogum
Waterproofing Systems	Gripset 2P	Gripset 38

NOTE

All on-site specifications and conditions are to comply with the respective waterproofing manufacturer's specifications and recommendations. Impresa Tile Showers Ltd. does not imply nor provide any warranties for any product listed herein.

STILE STAINLESS ALCOVE SHOWER

'INLINE' GLASS INSTALLATION

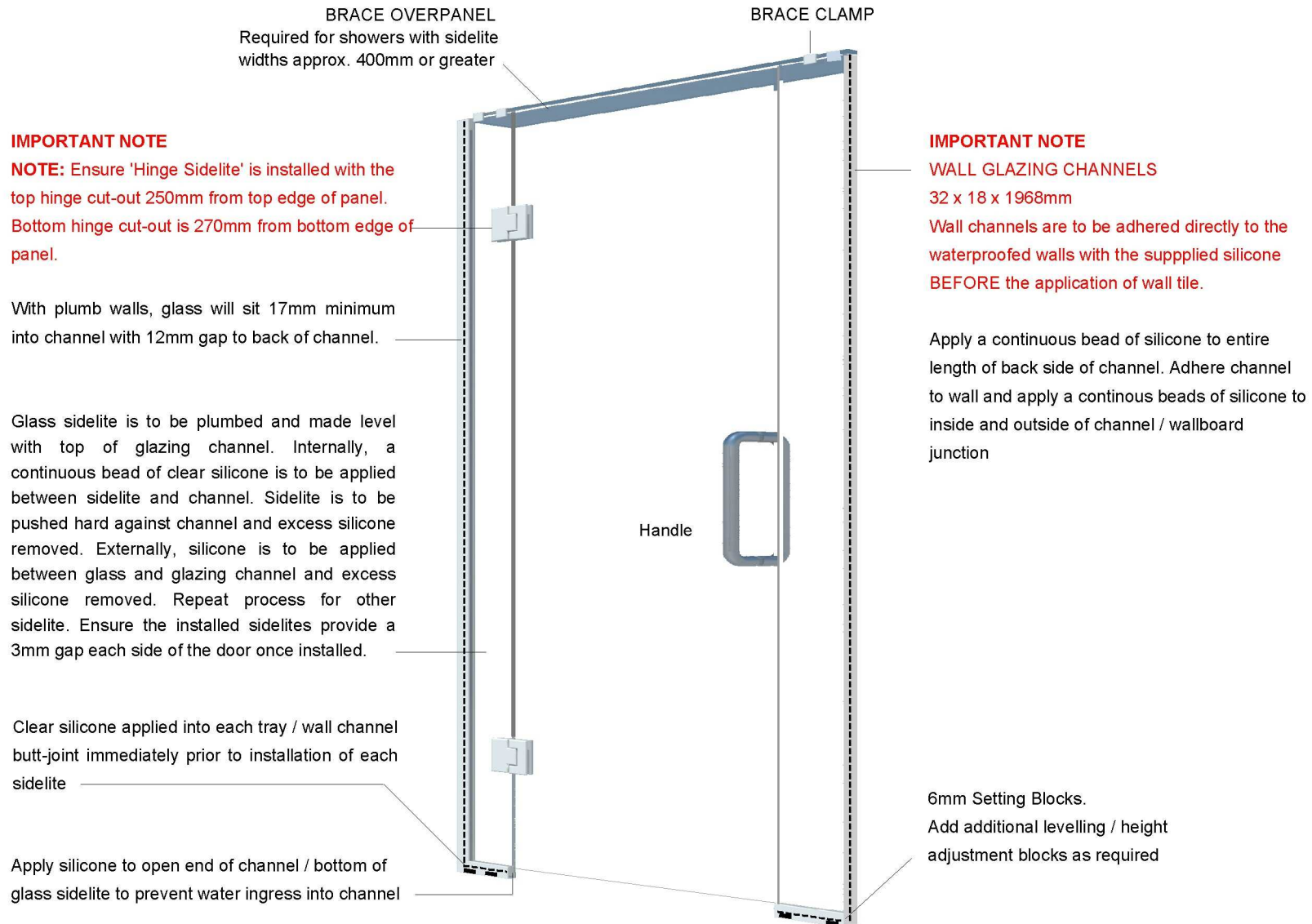

STILE STAINLESS CORNER SHOWER

GLASS INSTALLATION

IMPORTANT NOTE

WALL GLAZING CHANNELS

32 x 18 x 1968mm

Wall channels are to be adhered directly to the waterproofed walls with the supplied silicone BEFORE the application of wall tile.

Glass 'Return' panel is to be made plumb and level with top of glazing channel. Internally, a continuous bead of clear silicone is to be applied between glass and glazing channel. Return is to be pushed hard against channel and excess silicone removed. Externally, silicone is to be applied between glass and glazing channel and excess silicone removed.

With plumb walls, glass sits 17mm into channel with 12mm gap to back of channel.

A continuous bead of clear silicone to be applied to return panel edge. Ensuring sidelite is level with return panel and wall channel, insert sidelite into tray channel and adhere to return panel edge. Remove any excess silicone.

Clear silicone applied to each tray / wall channel butt-joint immediately prior to installation of sidelite or return panel.

Clear silicone to bottom of sidelites to seal-off end of channels

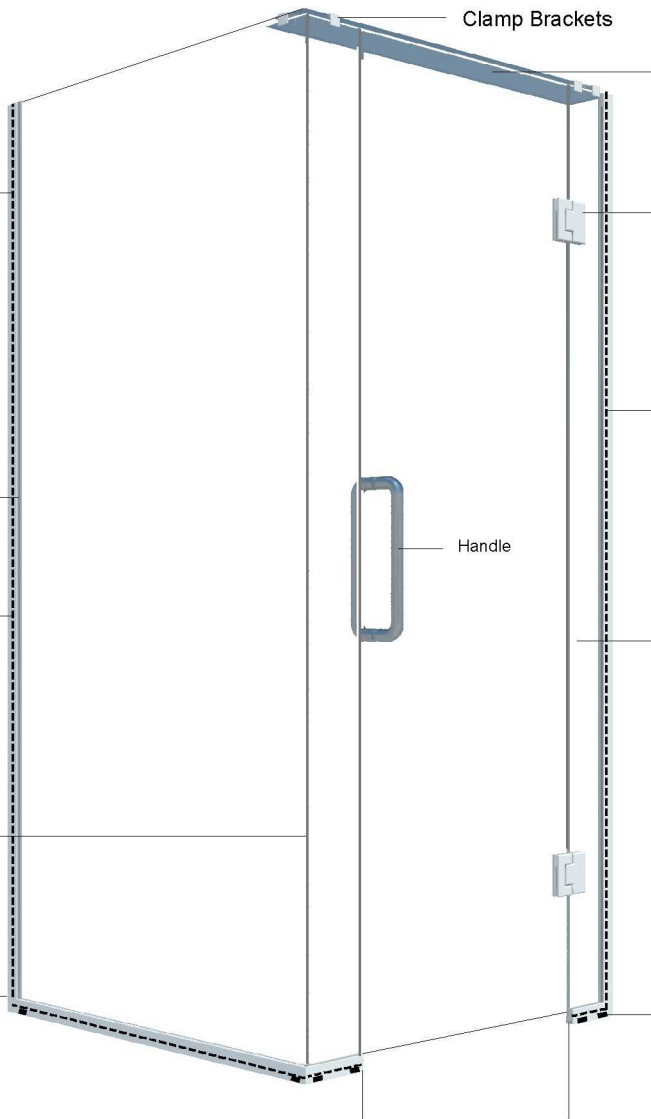

Clamp Brackets

Glass Brace Overpanel secured with silicone adhesive or Clamp Brackets.

NOTE: Ensure 'Hinge Sidelite' is installed with the top hinge cut-out 250mm from top edge of panel. Bottom hinge cut-out is 270mm from bottom edge of panel.

Glazing channel adhered to waterproofed wallboard with continuous bead of silicone applied to entire length of back side of channel and each channel / wallboard junction

Glass sidelite is to be plumbed and made level with top of glazing channel. Internally, a continuous bead of clear silicone is to be applied between sidelite and channel. Sidelite is to be pushed hard against channel and excess silicone removed. Externally, silicone is to be applied between glass and glazing channel and excess silicone removed. Ensure the installed sidelites provide a 3mm gap each side of the door once installed.

6mm Setting Blocks.

Add additional levelling / height adjustment blocks as required