

RECOMMENDED WATERPROOFING MEMBRANES

TRAY / WALL JOINTS & TRAY / FLOOR JOINTS OVERVIEW

Ensure the tray and side-upstands are clean. In accordance with the manufacturer's specifications / instructions, apply a primer 100mm min. up from the bottom edge of the shower wall linings, and a 100mm min. onto the bathroom floor area surrounding the front of the shower tray. DO NOT apply any primer onto the shower tray. Apply a peel and stick, fleece / mesh-lined butyl tape to span all shower tray side-upstand / wall lining joints. Apply a bead of an approved sealant to the tray threshold / bathroom floor joint for threshold-type trays. For trays with a frontal flange (trays which are to be rebated into the floor) apply a butyl tape and onto the bathroom floor. Apply a liquid waterproofing membrane to the shower walls, across the applied butyl tape and onto the tray side-upstands. Similarly, apply the waterproofing to the bathroom floor and lap onto the tray-frontal sealant or butyl tape. Refer to the waterproofing manufacturer's literature for specific instructions and for sheet membrane application. See 'On-Floor' or 'Level-Entry Floor' tray installation drawings on website.

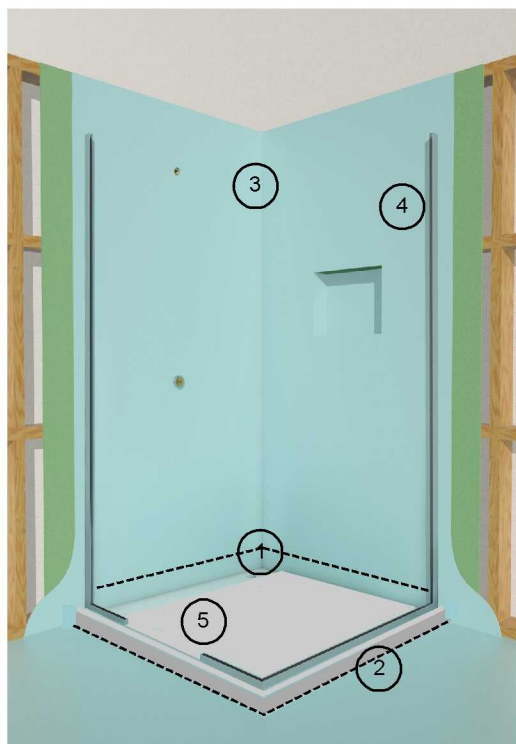

WATERPROOFING APPLICATION OVERVIEW

CAUTION: Before applying waterproofing to the shower walls, walk or jump on the tray to check the tray does not flex. If there is movement, the tray must be lifted and re-adhered correctly.

1. Fleece/mesh-lined butyl tape applied to the tray side-upstand / wall linings joint.
2. Waterproofing manufacturer's approved sealant applied to the tray / floor joint.
3. Selected cementitious, acrylic or polyurethane waterproofing membrane applied to shower wall linings and onto the butyl tape / tray side upstands.
4. Wall Glazing-channels installed directly to the cured waterproofing.
5. METRO Stainless shower tray. DO NOT apply waterproofing to the tray channel drain area. Ensure the tray is kept covered and clean.

WATERPROOFING MANUFACTURERS / SUPPLIERS

MANUFACTURER / SUPPLIER

Sika NZ
Ardex NZ
Bostick (NZ)
Construction Chemicals NZ
Construction Technologies
Davco
Flexco NZ
Mapei NZ
Technokolla (Protective Surfaces)
Waterproofing Systems

CEMENTITIOUS MEMBRANES

Sikalastic-152
Superflex WPM002
DampFix 3
Liquid Flash 2
AquaBlok 2
Dampfast
Miracryl
Mapelastic Smart
Rasolastik
Gripset 2P

ACRYLIC / URETHANE MEMBRANES

Sikalastic-220W
WPM155 Rapid
DampFix Gold
Hydrathane
AquaBlok W1
Dampflex
Flexi-Seal
Aquadefense
Rasogum
Gripset 38

NOTE

All on-site specifications and conditions are to comply with the respective waterproofing manufacturer's specifications and recommendations. Impresa Tile Showers Ltd. does not imply nor provide any warranties for any product listed herein.