

NOTE: METRO shower trays are one-piece, epoxy-coated aluminium. DO NOT apply liquid waterproofing membrane directly to the tray.

TRAY / WALL JOINTS & TRAY / FLOOR JOINTS OVERVIEW

Ensure the tray and side-upstands are clean. In accordance with the manufacturer's specifications / instructions, apply a primer 100mm min. up from the bottom edge of the shower wall linings, and a 100mm min. onto the bathroom floor area surrounding the front of the shower tray. DO NOT apply any primer onto the shower tray. Apply a peel and stick, fleece / mesh-lined butyl tape to span all shower tray side-upstand / wall lining joints. Apply a butyl tape to the tray front threshold (or flange, if part of tray design and tray is to be rebated into the floor) and onto the bathroom floor. Apply a liquid waterproofing membrane to the shower walls, across the applied butyl tape and onto the tray side-upstands. Similarly, apply the waterproofing to the bathroom floor and lap onto the tray-front threshold or flange. DO NOT apply waterproofing to the tray internal standing area. Refer to the waterproofing manufacturer's literature for specific instructions and for sheet membrane application. See 'On-Floor' or 'Level-Entry Floor' tray installation drawings on website.

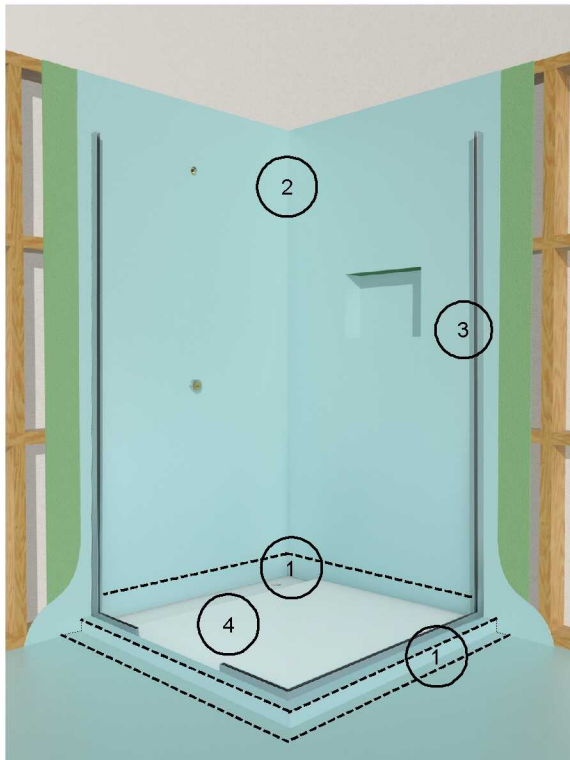

WATERPROOFING APPLICATION OVERVIEW

CAUTION: Before applying waterproofing to the shower walls, walk or jump on the tray to check the tray does not flex. If there is movement, the tray must be lifted and re-adhered correctly.

1. Fleece/mesh-lined butyl tape applied to the tray side-upstand / wall linings joint, and the tray threshold / bathroom floor joint before the application of a waterproofing membrane.
2. Selected cementitious, acrylic or polyurethane waterproofing membrane applied to shower wall linings and onto the butyl tape / tray side upstands.
3. Wall Glazing-channels installed directly to the cured waterproofing.
4. METRO shower tray. DO NOT apply waterproofing to the tray flat, standing area. Ensure the tray is kept covered and clean.

WATERPROOFING MANUFACTURERS / SUPPLIERS

MANUFACTURER / SUPPLIER

Sika NZ
 Ardex NZ
 Bostick (NZ)
 Construction Chemicals NZ
 Construction Technologies
 Davco
 Flexco NZ
 Mapei NZ
 Technokolla (Protective Surfaces)
 Waterproofing Systems

CEMENTITIOUS MEMBRANES

Sikalastic-152
 Superflex WPM002
 DampFix 3
 Liquid Flash 2
 AquaBlok 2
 Dampfast
 Miracryl
 Mapelastik Smart
 Rasolastik
 Gripset 2P

ACRYLIC / URETHANE MEMBRANES

Sikalastic-220W
 WPM155 Rapid
 DampFix Gold
 Hydrathane
 AquaBlok W1
 Dampflex
 Flexi-Seal
 Aquadefense
 Rasogum
 Gripset 38

NOTE

All on-site specifications and conditions are to comply with the respective waterproofing manufacturer's specifications and recommendations. Impresa Tile Showers Ltd. does not imply nor provide any warranties for any product listed herein.