

# URBIS Stainless

## RECOMMENDED WATERPROOFING MEMBRANES

### TRAY / WALL JOINTS & TRAY / FLOOR JOINTS OVERVIEW

Ensure the tray and side-upstands are clean. In accordance with the manufacturer's specifications / instructions, apply a primer 100mm min. up from the bottom edge of the shower wall linings, and a 100mm min. onto the bathroom floor area surrounding the front of the shower tray. DO NOT apply any primer onto the shower tray. Apply a peel and stick, fleece / mesh-lined butyl tape to span all shower tray side-upstand / wall lining joints. Apply a butyl tape to the tray front threshold (or flange, if part of tray design and tray is to be rebated into the floor) and onto the bathroom floor. Apply a liquid waterproofing membrane to the shower walls, across the applied butyl tape and onto the tray side-upstands. Similarly, apply the waterproofing to the bathroom floor and lap onto the tray-front threshold or flange. Refer to the waterproofing manufacturer's literature for specific instructions and for sheet membrane application. See 'On-Floor' or 'Level-Entry Floor' tray installation drawings on website.

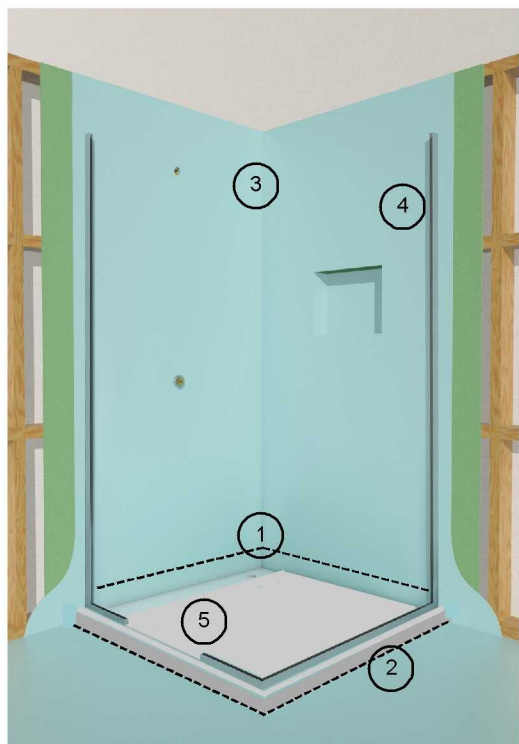

### WATERPROOFING APPLICATION OVERVIEW

**CAUTION:** Before applying waterproofing to the shower walls, walk or jump on the tray to check the tray does not flex. If there is movement, the tray must be lifted and re-adhered correctly.

1. Fleece/mesh-lined butyl tape applied to the tray side-upstand / wall linings joint.
2. Waterproofing manufacturer's approved sealant applied to the tray / floor joint.
3. Selected cementitious, acrylic or polyurethane waterproofing membrane applied to shower wall linings and onto the butyl tape / tray side upstands.
4. Wall Glazing-channels installed directly to the cured waterproofing.
5. URBIS Stainless shower tray. DO NOT apply waterproofing to the tray channel drain area. Ensure the tray is kept covered and clean.

### WATERPROOFING MANUFACTURERS / SUPPLIERS

#### MANUFACTURER / SUPPLIER

Sika NZ  
Ardex NZ  
Bostick (NZ)  
Construction Chemicals NZ  
Construction Technologies  
Davco  
Flexco NZ  
Mapei NZ  
Technokolla (Protective Surfaces)  
Waterproofing Systems

#### CEMENTITIOUS MEMBRANES

Sikalastic-152  
Superflex WPM002  
DampFix 3  
Liquid Flash 2  
AquaBlok 2  
Dampfast  
Miracryl  
Mapelastik Smart  
Rasolastik  
Gripset 2P

#### ACRYLIC / URETHANE MEMBRANES

Sikalastic-220W  
WPM155 Rapid  
DampFix Gold  
Hydrathane  
AquaBlok W1  
Dampflex  
Flexi-Seal  
Aquadefense  
Rasogum  
Gripset 38

#### NOTE

All on-site specifications and conditions are to comply with the respective waterproofing manufacturer's specifications and recommendations. Impresa Tile Showers Ltd. does not imply nor provide any warranties for any product listed herein.