

Stile Stainless Shower

INSTALLATION INSTRUCTIONS



Impresa Tile Showers Ltd.

P. 09 273 4545 E. support@impresa.co.nz

SHOWER INSTALLATION

STEP 1

FRAMING

Ensure framing is plumb or no greater than 10mm out of plumb.

Ensure the floor is no greater than 5mm out of level.

Install a row of nogs around tray height to allow fixing for bottom of wet-wall lining.

Install nogs as required if a Quik Niche is to be utilised.



WASTE-TRAP POSITION / INSTALLATION

Determine easy-clean waste-trap position by placing the shower tray onto the floor 7mm off the bottom plate / framing. Mark the perimeter of the waste hole on the floor and cut a hole in the floor to position the easy-clean waste-trap. Connect the waste-trap to the waste outlet pipe, ensuring the easy-clean waste-trap is level with the floor. Alternatively, if an option, for timber / plywood mid-floor installations, connect the waste-trap to the tray and outlet pipe from under the floor below the tray.

STEP 2

TILE ADHESIVE APPLIED TO SHOWER FLOOR AND TRAY

Ensure the shower-area floor surface is free of dirt and dust. Mix tile adhesive to a 'stiff' consistency which allows adhesive to remain stuck on tray foam support pads when tray is lifted to a vertical position at time of placement. Using a 10mm notched trowel, apply tile adhesive to the shower-area floor.

Lay shower tray flat with underside and foam pads facing up. Apply a thin 'primer' amount of tile adhesive to each foam pad on tray underside then apply a minimum 10mm thickness of adhesive to each foam support, adding extra adhesive as required for uneven / unlevel floors.



STEP 3

PLACEMENT AND INSTALLATION OF TRAY

With adhesive on tray foam pads and shower floor area, gently place shower into the required area. Ensure the tray is level along the 'door side' of the tray and from that point across to the other corner of the tray. Push the tray down or lift the tray up and add extra adhesive as required to make tray level.

Lightly tap-down the entire tray to ensure bonding between the adhesive on the tray and the floor.

CAUTION: Ensure the tray is level or no greater than 5mm out of level from corner to corner at both walls.

Do not apply any heavy weights to the tray. Allow 24 hours for adhesive to cure sufficiently before walking on tray. When adhesive is cured, stand and walk on tray to check it is well bonded to floor and is not flexing.

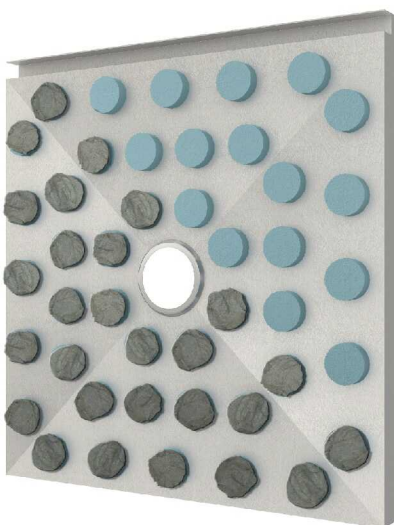

SHOWER INSTALLATION



STEP 4

WASTE-TRAP / TRAY ALIGNMENT AND INSTALLATION

With waste-trap bottom 'O' ring on the waste body, ensure the waste-trap and tray hole-outlet align and that the 'O' ring on the waste body is touching the bottom of the tray outlet hole. Screw the waste top chrome ring a few rotations into the trap body. Apply silicone to underside of waste screw-ring and fully tighten the screw-ring to tray. Alternatively, if possible, attach the waste-trap to the tray from underneath the bathroom floor.

If not done prior, install a row of nogs to framing at tray height to allow fixing of bottom edge of wet-wall lining.



STEP 5

CHECK TRAY ADHESION TO FLOOR

CAUTION: To ensure the tray is well-bonded to the floor, stand and move about on the tray, checking for flexing / movement of the tray. If there is any movement, lift the tray and re-adhere.

QUIK NICHE INSTALLATION

If required, install Quik Niche as per Impresa instructions supplied with niche.

WALLBOARD INSTALLATION

Before affixing wallboard, ensure the shower wall framing is plumb or not more than 10mm out of plumb -- pack wall to suit if required.

Cut and affix wet-area wallboard to framing as per manufacturer's instructions.

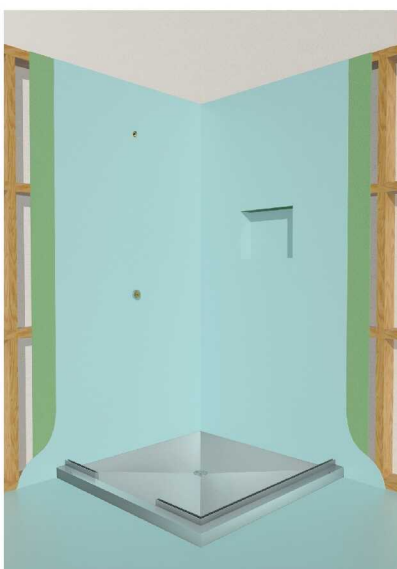

STEP 6

PRE-WATERPROOFING CHECK

Prior to application of waterproofing membrane, ensure the shower walls are plumb or no more than 10mm out of plumb.

CAUTION: Tiler or waterproofer should check the tray is solidly-bonded to the floor and is not flexing BEFORE proceeding with the application of a waterproofing membrane.

JOINT TAPE AND LIQUID WATERPROOFING MEMBRANE APPLICATION

In accordance with the manufacturer's specifications and instructions, apply a primer to the shower wall linings and bathroom floor.

Apply a peel and stick butyl tape to span the tray side-upstand / wall lining joints. Brush or roll a liquid waterproofing membrane to the shower walls and down across the applied butyl tape and onto the tray sides. Apply the liquid waterproofing to the bathroom floor and up to the tray front threshold and seal the floor / threshold joint with silicone sealant. If a flange surrounds the front of the tray, apply a butyl tape to the tray / floor joint and apply the liquid membrane from the floor and onto the butyl tape.

For sheet membranes, refer to the manufacturer's instructions.



STEP 8

WALL GLAZING CHANNEL INSTALLATION

Showers which are to have walls finished with tile, the wall glazing channels are to be adhered directly to the waterproofed walls with the supplied silicone adhesive BEFORE the wall tile is applied.

Showers which are to have walls finished with Hardiglaze / Seratone / Aquapanel / acrylic liner or similar wet-wall panel lining approx. 3-6mm thickness -- install wet-wall panels first and then adhere the wall channel with the supplied silicone adhesive.

Place a spirit level against the inside face of tray glazing channel and mark the 'plumb' position on the wall. Repeat procedure on other wall. Ensure the wall channel that receives the 'Hinge panel' (panel to which door hinges attach to) is cut to 1970mm. Second wall channel to be installed to same level as the top of the 'Hinge panel' wall channel. Apply a bead of supplied silicone adhesive to bottom side of pre-cut wall glazing channels, and adhere each channel to the wall at the pre-marked plumb position. Apply bead of silicone to the inside and outside channel / wall junctions. Check wall channels are both level with each other at the top, and plumb 'left-to-right'.



STEP 9

PLUMBING FIXTURES INSTALLATION

Install plumbing fixtures to shower.

STEP 10

GLASS INSTALLATION

Impresa recommends the installation of the frameless-glass enclosure be performed by an experienced frameless-glass installer.

See Glazing Installation Overview -- click the 'Technical / Drawings' button on the STILE STAINLESS page -- www.impresa.co.nz.

STILE STAINLESS SHOWER TRAY

EASY-CLEAN WASTE ECW9050 INSTALLATION

It is the sole responsibility of the installer to ensure a perfect water seal between the inner ring-flange and the shower tray by applying a 'wet-area' neutral-cure silicone sealant.



Step 1

Apply a generous bead of a 'wet-area' neutral-cure silicone sealant around the top and underside of the tray waste outlet hole.

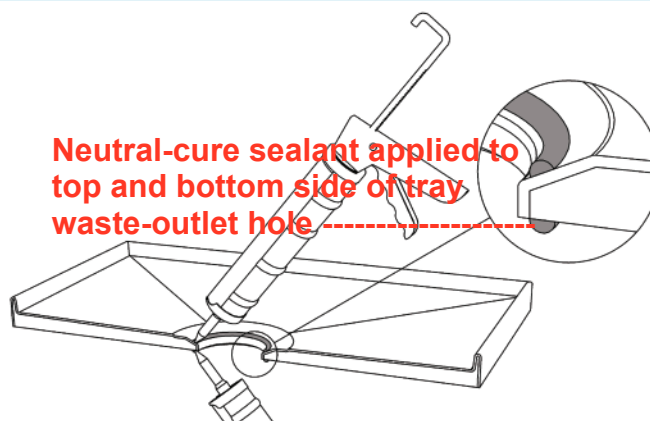

Step 2

Insert the inner ring-flange into the waste trap body and screw the ring-flange down onto the tray, firmly but not excessively using the key / cap tool provided.

Lightly spray water over any excess sealant and remove the excess sealant.

Leave the key / cap tool in place to prevent debris entering the waste outlet.

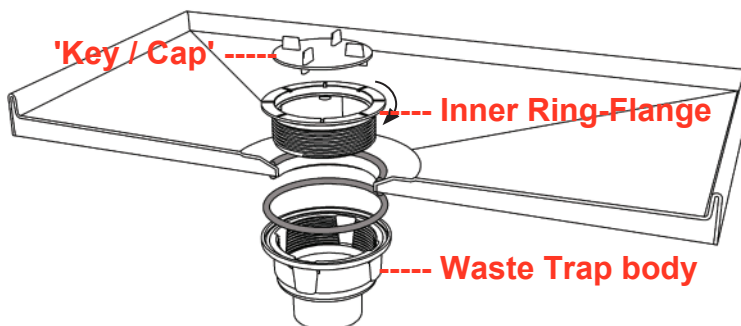

Step 3

Install the inner cup into the waste trap body. Install the chrome lid and rotate it while pressing downwards until the lugs on the lid click into place.

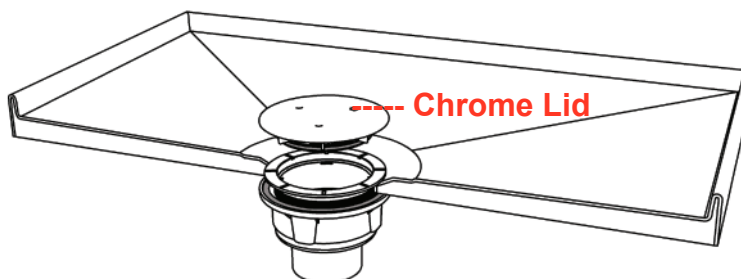

STAINLESS STEEL SHOWER TRAY

INSTALLATION ADHESIVES

(A) Ardex NZ -- ARDEX X77

(D) ASA Bostik NZ -- CONFLEX

(B) Australasian Tiling Adhesives -- AUSFLEX GOLD

(E) Cemix Products Ltd. -- RUBBERFLEX

(C) Construction Chemicals NZ -- DURAFLEX

(F) Davco -- ULTRAFLEX

TILE ADHESIVE APPLICATION TO TRAY AND FLOOR

A recommended thinset tile adhesive is to be applied to a minimum 10mm-thickness to each of the high-density foam pads on the bottom of the tray, AND to the shower area floor with a 10mm notched-trowel.

NOTE

All on-site specifications and conditions are to comply with the respective adhesive manufacturer's specifications and recommendations. Impresa Tile Showers Ltd. does not imply nor provide any warranties for any tile adhesive listed herein.

RECOMMENDED WATERPROOFING MEMBRANES

SHOWER TRAY / WALL JOINT

In general terms and in accordance with the manufacturer's specifications and instructions, apply a primer 100mm min. up from the bottom edge of the shower wall linings, and a 100mm min. onto the bathroom floor area surrounding the front of the shower tray. DO NOT apply any primer onto the shower tray. Apply a peel and stick butyl tape to span all shower tray side / shower wall lining joints. Brush or roll a liquid waterproofing membrane to the shower walls, across the applied butyl tape and onto the shower tray sides.

For sheet membranes, refer to the manufacturer's instructions.

SHOWER TRAY / FLOOR JOINT

Apply a butyl tape 10mm onto the tray threshold and out onto the primed bathroom floor or seal the tray / floor joint with an approved sealant. Brush or roll liquid waterproofing to the bathroom floor, lapping onto the applied butyl tape or sealant.

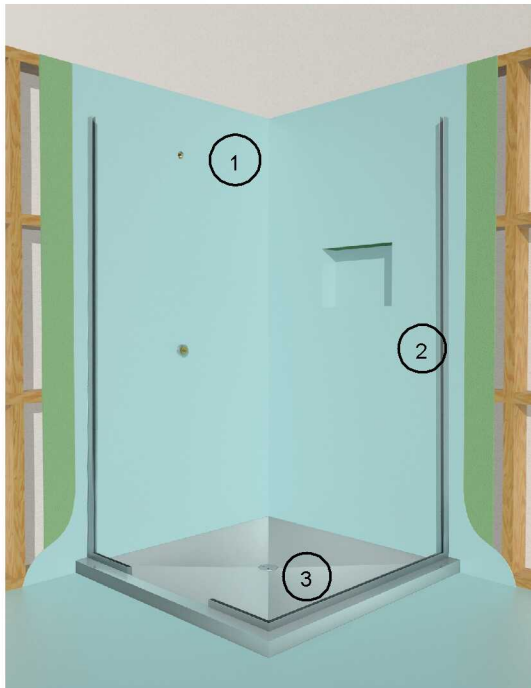

WATERPROOFING APPLICATION OVERVIEW

NOTE: Before applying the waterproofing, ensure the tray does not flex due to the action of a person walking or moving on the tray. If there is flexural movement of the tray, it must be lifted and re-adhered correctly.

1. Selected cementitious or acrylic waterproofing membrane from list below applied to shower wall linings.
2. Wall Glazing-channels installed directly to cured waterproofing.
3. STILE STAINLESS shower tray.
4. Waterproofing to be applied to shower wall as per manufacturer's specifications. Ensure waterproofing is fully hard-cured before applying tiles.

WATERPROOFING MANUFACTURERS / SUPPLIERS

MANUFACTURER / SUPPLIER

Sika NZ
Ardex NZ
Bostick (NZ)
Construction Chemicals NZ
Construction Technologies
Davco
Flexco NZ
Mapei NZ
Technokolla (Protective Surfaces)
Waterproofing Systems

CEMENTITIOUS MEMBRANES

Sikalastic-152
Superflex WPM002
DampFix 3
Liquid Flash 2
AquaBlok 2
Dampfast
Miracryl
Mapelastik Smart
Rasolastik
Gripset 2P

ACRYLIC / URETHANE MEMBRANES

Sikalastic-220W
WPM155 Rapid
DampFix Gold
Hydrathane
AquaBlok W1
Dampflex
Flexi-Seal
Aquadefense
Rasogum
Gripset 38

NOTE

All on-site specifications and conditions are to comply with the respective waterproofing manufacturer's specifications and recommendations. Impresa Tile Showers Ltd. does not imply nor provide any warranties for any product listed herein.

STILE STAINLESS & METRO STAINLESS SHOWER

ALCOVE / INLINE GLASS ENCLOSURE INSTALLATION

IMPORTANT NOTE

HINGE PANEL -- to be installed with the top hinge notch beginning 250mm from top edge of panel. Bottom hinge notch is 270mm from bottom edge of panel.

With plumb walls, glass will sit approx. 10mm into channel.

GLASS HINGE PANEL is to be made plumb and made level with top of glazing channel. Internally, a continuous bead of clear silicone is to be applied between sidelite and channel. Glass panel is to be pushed hard against channel and excess silicone removed. Externally, silicone is to be applied between glass and glazing channel and excess silicone removed. Ensure the installed panel is flush with the end of the tray glazing channel.

Clear silicone applied into each tray / wall channel butt-joint immediately prior to installation of each sidelite.

Apply silicone to open end of channel / bottom of glass sidelite to prevent water ingress into channel.

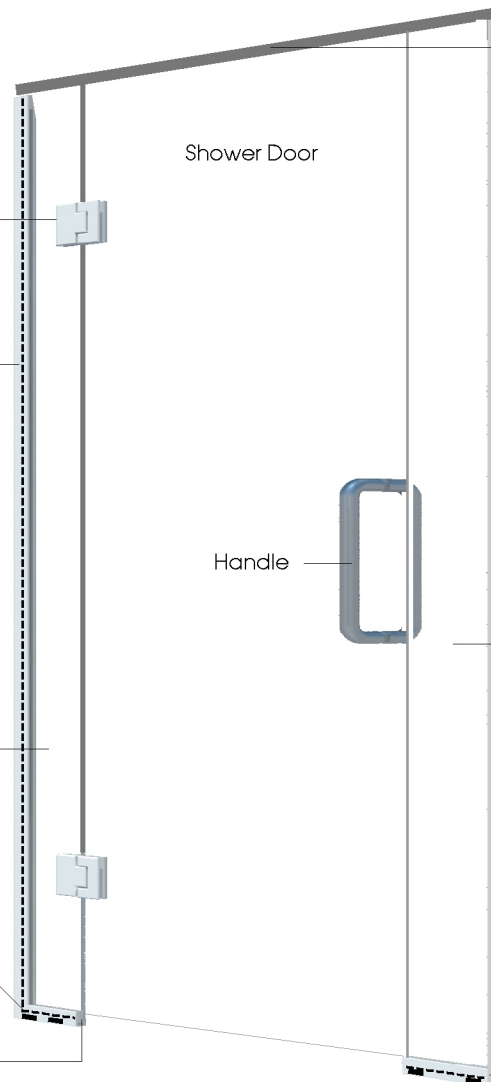

ALUMINIUM BRACE BAR

Secured with silicone adhesive or Clamp Brackets. Optional glass panel available.

IMPORTANT NOTE

WALL GLAZING CHANNELS

Wall channels are to be adhered directly to the waterproofed walls with the supplied silicone BEFORE the application of wall tile.

Apply a continuous bead of silicone to entire length of back side of channel. Adhere channel to wall and apply a continuous beads of silicone to inside and outside of channel / wallboard junction.

GLASS SIDE PANEL -- Install setting blocks into the tray channel and ensure the Side Panel top edge is flush with the wall channel and the Hinge Panel. Place the panel into the tray and wall channels. On the shower internal side, apply silicone between the wall channel and glass panel. Press the Side Panel hard against the channel. Spray water mixture and remove all excess silicone.

SETTING BLOCKS -- Use 6 x 5mm blocks under bottom edge of glass panels to ensure panels are level with top of wall channels or 1.5mm max. above.

STILE STAINLESS SHOWER & METRO STAINLESS SHOWER

CORNER GLASS ENCLOSURE INSTALLATION

IMPORTANT NOTE

WALL GLAZING CHANNELS

Wall channels are to be adhered directly to the waterproofed walls with the supplied silicone BEFORE the application of wall tile.

GLASS RETURN PANEL -- is to be made plumb and level with top of glazing channel and Hinge Panel. Internally, apply a continuous bead of clear silicone between glass and glazing channel. Return is to be pushed hard against channel and excess silicone removed. Externally, silicone is to be applied between glass and glazing channel and excess silicone removed.

GLASS SIDE PANEL -- Install setting blocks into the tray channel and ensure the Side Panel top edge is flush with the Return Panel. Apply a continuous bead of clear silicone approx. 5mm thick to the Return Panel edge. Insert the Side Panel into the tray channel and press / adhere the Side Panel to the Return panel edge leaving a 2mm silicone joint between both panels. Spray water mixture and remove all excess silicone.

Clear silicone applied to each tray / wall channel butt-joint immediately prior to installation of sidelite or return panel.

Apply clear silicone to bottom of side panels to seal-off end of channels.

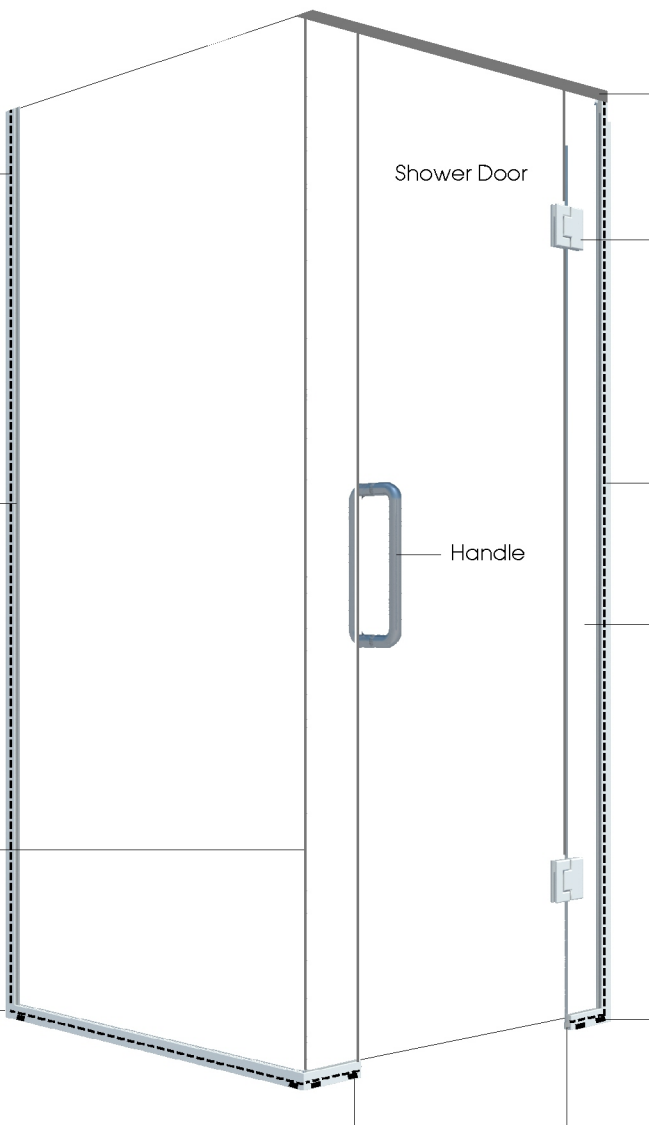

ALUMINIUM BRACE BAR

Secured with silicone adhesive or Clamp Brackets. Optional glass panel available.

IMPORTANT NOTE:

HINGE PANEL -- to be installed with the top hinge notch 250mm from top edge of panel. Bottom hinge cut-out is 270mm from bottom edge of panel.

With plumb walls, glass will sit approx. 10mm into channel.

GLASS HINGE PANEL is to be made plumb and made level with top of glazing channel. Internally, a continuous bead of clear silicone is to be applied between sidelite and channel. Glass panel is to be pushed hard against channel and excess silicone removed. Externally, silicone is to be applied between glass and glazing channel and excess silicone removed. Ensure the installed panel is flush with the end of the tray glazing channel.

SETTING BLOCKS -- Use 6 x 5mm blocks under bottom edge of glass panels to ensure panels are level with top of wall channels or 1.5mm max. above.