

URBIS Shower

INSTALLATION INSTRUCTIONS



Impresa Tile Showers Ltd.

P. 09 273 4545 E. support@impresa.co.nz

SHOWER INSTALLATION



STEP 1

FRAMING

Ensure framing is plumb or no greater than 10mm out of plumb.

Ensure the floor is no greater than 5mm out of level.

Install a row of nogs around tray height to allow fixing for bottom of wet-wall lining.

Install nogs as required if a Quik Niche is to be utilised.

PLUMBING INSTALLATION

Install shower mixer, and hot and cold piping as required.

Easy-clean Waste-Trap position is determined by placing the shower tray on floor ensuring there is a 7mm gap between the tray and framing. Connect the waste-trap to the outlet pipe or if possible or easier, connect the waste-trap after the installation of the tray.



STEP 2

TILE ADHESIVE APPLIED TO SHOWER FLOOR AND TRAY

Ensure the shower-area floor surface is free of dirt and dust. Mix tile adhesive to a 'stiff' consistency which allows adhesive to remain stuck on tray foam support pads when tray is lifted to a vertical position at time of placement. Using a 10mm notched trowel, apply tile adhesive to the shower-area floor.

Lay shower tray flat with underside and foam pads facing up. Apply a thin 'primer' amount of tile adhesive to each foam pad on tray underside then apply a minimum 10mm thickness of adhesive to each foam support, adding extra adhesive as required for uneven / unlevel floors.

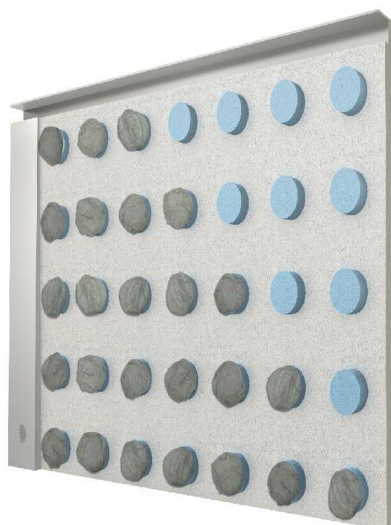

STEP 3

PLACEMENT AND INSTALLATION OF TRAY

With adhesive on tray foam pads and shower floor area, gently place shower into the required area. Ensure the tray is level along the 'door side' of the tray and from that point across to the other corner of the tray. Push the tray down or lift the tray up and add extra adhesive as required to make tray level.

Lightly tap-down the entire tray to ensure bonding between the adhesive on the tray and the floor. Check the tray is level or no greater than 5mm out of level from corner to corner at both walls.

Do not apply any heavy weights to the tray. Do not stand on the tray before adhesive has cured. Allow 24 hours for adhesive to cure. Once the adhesive has cured, stand and walk on tray to check it is well bonded to floor and is not flexing.

SHOWER INSTALLATION

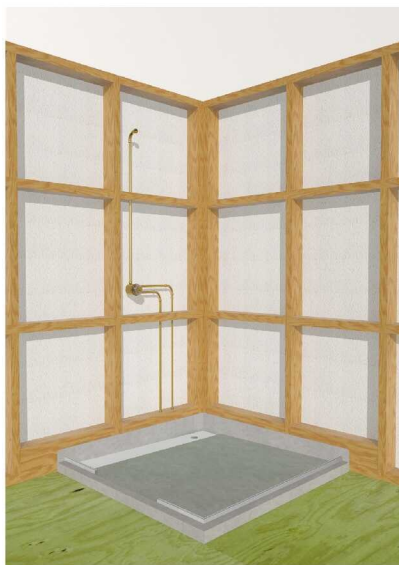

STEP 4

WASTE-TRAP / TRAY ALIGNMENT AND INSTALLATION

With waste-trap bottom 'O' ring on the waste body, ensure the waste-trap and tray hole-outlet align and that the 'O' ring on the waste body is touching the bottom of the tray outlet hole. Screw the waste top chrome ring a few rotations into the trap body. Apply silicone to underside of waste screw-ring and fully tighten the screw-ring to tray. Alternatively, if possible, attach the waste-trap to the tray from underneath the bathroom floor.

If not done prior, install a row of nogs to framing at tray height to allow fixing of bottom edge of wet-wall lining.

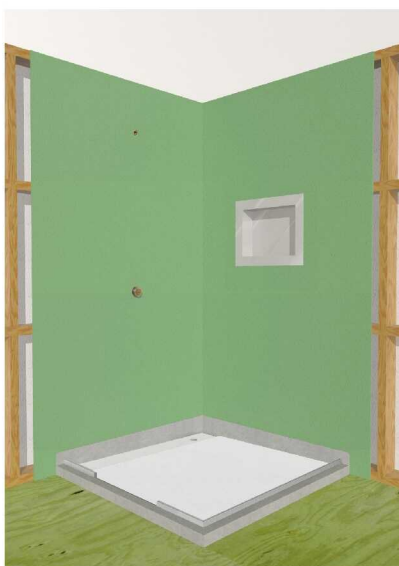

STEP 5

CHECK TRAY ADHESION TO FLOOR

To ensure the tray is well-bonded to the floor, stand and move about on the tray, checking for flexing / movement of the tray. If there is any movement, lift the tray and re-adhere.

QUIK NICHE INSTALLATION

If required, install Quik Niche as per Impresa instructions supplied with niche.

WALLBOARD INSTALLATION

Before affixing wallboard, ensure the shower wall framing is plumb or not more than 10mm out of plumb -- pack wall to suit if required.

Cut and affix wet-area wallboard to framing as per manufacturer's instructions.

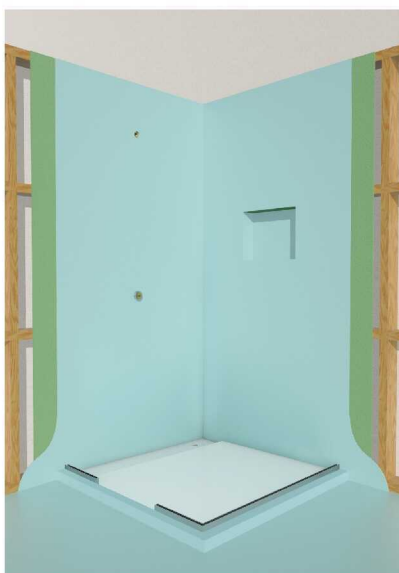

STEP 6

PRE-WATERPROOFING CHECK

Prior to application of waterproofing membrane, ensure the shower walls are plumb or no more than 10mm out of plumb.

CAUTION: Tiler or waterproofer should check the tray is solidly-bonded to the floor and is not flexing BEFORE proceeding with the application of a waterproofing membrane.

JOINT TAPE AND WATERPROOFING MEMBRANE APPLICATION

In accordance with the manufacturer's specifications and instructions, apply a primer to the shower wall linings and bathroom floor.

Apply a peel and stick butyl tape to span the tray side-upstand / wall lining joints, and a further butyl tape to the tray front threshold or flange and onto the bathroom floor. Brush or roll a liquid waterproofing membrane to the shower walls and down across the applied butyl tape and onto the tray sides. Apply the liquid waterproofing to the bathroom floor and onto the butyl tape applied to the tray front threshold or flange.

For sheet membranes, refer to the manufacturer's instructions.



STEP 7

WALL GLAZING CHANNEL INSTALLATION

Wall glazing channels are to be adhered to the waterproofed walls BEFORE tile is applied.

Place an 1800mm-long spirit level against the inside face of tray glazing channel and mark the 'plumb' position on the wall. Repeat procedure on other wall.

Standard Wall Channel Height -- Both supplied wall channels are pre-cut at 1965mm. Ensure the wall channel that receives the glass 'Hinge Panel' (panel that door hinges attach to) is installed at the supplied length of 1965mm. Trim the second wall channel length / height if necessary to ensure the channel is level with the corresponding Hinge Panel channel. Apply a bead of supplied silicone sealant / adhesive to the bottom side of both pre-cut wall glazing channels and adhere each to the wall at the pre-marked plumb position. Apply a second and third bead to the inside and outside channel / wall junctions. With an 1800mm-long level, check each channel is plumb, and level with each other at the top.

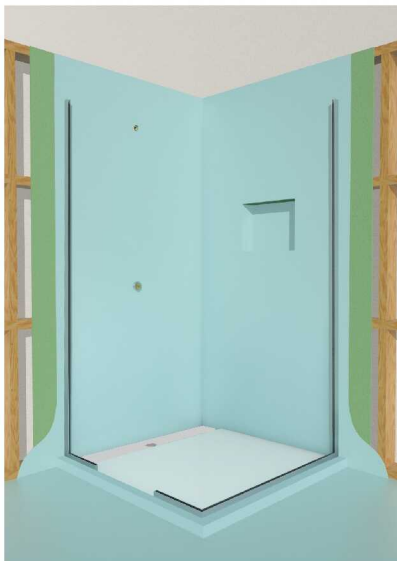

STEP 8

TILE APPLICATION

The tiler should check the tray has been well-bonded to the floor and is not flexing BEFORE proceeding with tile installation.

The recommended tray tile adhesives are **Mapei 'Kerapoxy Adhesive'** or **Sika 'Sikadur-32 Normal'**. Apply as per the manufacturer's instructions.

Install tile onto the tray except for a 110mm-wide strip along the wall at which the waste outlet is located. When tiling is complete, there should be a strip of white paint-coated, untiled tray showing. Ensure all tile finishes flush or 1-2mm above the channel cover / grate height when in-situ. After completion of the tray tile installation, apply tile to the shower walls.

All tiling should comply with BRANZ recommendations, industry standards, and tile adhesive manufacturer's specifications.



STEP 9

PLUMBING FIXTURES INSTALLATION

Install plumbing fixtures to shower.

STEP 10

GLASS INSTALLATION

Impresa recommends the installation of the frameless-glass enclosure be performed by an experienced frameless-glass installer.

See Glazing Installation Overview -- click the 'Technical / Drawings' button on the URBIS page -- www.impresa.co.nz.

URBIS

EASY CLEAN WASTE TRAP (ECW4040) SPECIFICATIONS AND INSTALLATION

EASY-CLEAN WASTE TRAP SCHEMATIC

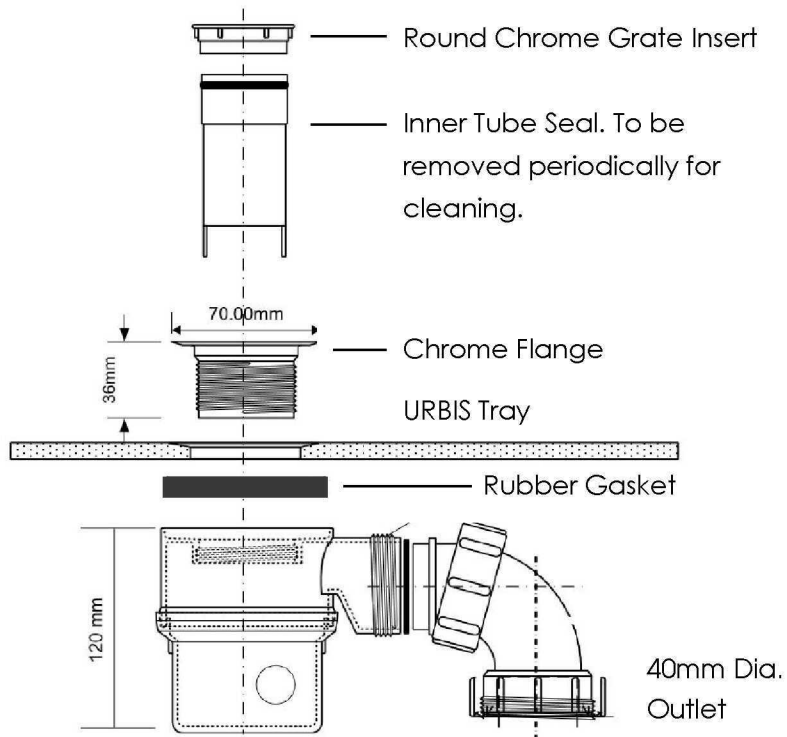

EASY-CLEAN TRAP OPTION

Flow Rate: 21 litres / min
Water Seal: 50mm Inner Tube/Seal Ring
Inlet Size Dia: 40mm / Outlet Size Dia: 40mm
Body Overall Depth: 120mm
DWV pipe compliant with AS/NZS1260

INSTALLATION -- Neutral-cure silicone is to be applied to the bottom side of the Chrome Flange and threaded into the easy-clean body and tightened down onto the shower tray.

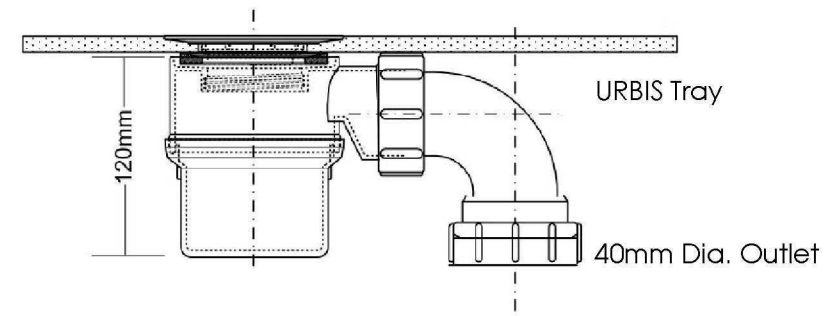

WASTE FITTING OPTION

Removal of the Inner Tube-Seal creates a waste-fitting to which a 40mm, 50mm diameter or larger outlet pipe can be connected. A P-Trap or S-Trap must be connected to the waste fitting to prevent the egress of sewer gases.

SHOWER TRAY INSTALLATION ADHESIVES

TRAY TILE APPLICATION ADHESIVES

TRAY INSTALLATION TO FLOOR

Apply one of the recommended thinset tile adhesives below to a minimum 10mm-thickness to each of the high-density foam pads on the bottom of the tray, AND to the shower area floor with a 10mm notched-trowel.

RECOMMENDED TILE ADHESIVES

(A) Ardex NZ -- **ARDEX X77**

(B) Australasian Tiling Adhesives -- **AUSFLEX GOLD**

(C) Construction Chemicals NZ -- **DURAFLEX**

(D) ASA Bostik NZ -- **CONFLEX**

(E) Laticrete -- **LATAFLEX GOLD**

(F) Cemix Products -- **RUBBERFLEX**

(G) Davco -- **ULTRAFLEX**

TILE APPLICATION TO SHOWER TRAY

Impresa tileable aluminium shower trays are supplied with a white epoxy coating. All ceramic and porcelain tile is to be adhered directly to the tray with one of the following epoxy adhesives --

RECOMMENDED TILE ADHESIVES

Mapei NZ -- **Kerapoxy Adhesive** (epoxy adhesive). For 10mm-thick tile use with 8mm or 10mm trowel.

Sika NZ -- **Sikadur-32 Normal** (epoxy adhesive). For 10mm-thick tile use with 8mm or 10mm trowel.

For smaller and / or thinner tile, use an appropriate smaller-depth trowel size.

NOTE

All on-site specifications and conditions are to comply with the respective adhesive manufacturer's specifications and recommendations. Impresa Tile Showers Ltd. does not imply nor provide any warranties for any tile adhesive listed herein.

Impresa Showers

Ph: 09 273 4545 support@impresa.co.nz

The URBIS tray should be installed so the wallboard finishes at the top of the tray side upstands and flush with the same side upstands. A butyl tape is required to bridge the tray side / wallboard joint prior to the application of a recommended waterproofing membrane to the shower walls (see waterproofing manufacturer's application instructions).

NOTE: The wall glazing channels are to be adhered directly to the waterproofed walls PRIOR to the application of wall tile.



WATERPROOFING APPLICATION OVERVIEW

NOTE: Ensure tray has been correctly installed and is not flexing with the weight of a person walking / standing

1. Selected cementitious or acrylic waterproofing membrane from list below applied to shower wall linings.
2. Wall Glazing-channels installed directly to cured waterproofing.
3. URBIS shower tray with waterproofed shower walls. Do NOT apply waterproofing to any area on the shower tray.
4. Ensure waterproofing is fully hard-cured before applying tiles.

WATERPROOFING MANUFACTURERS / SUPPLIERS

MANUFACTURER / SUPPLIER

Sika NZ
Ardex NZ
Bostick (NZ)
Construction Chemicals NZ
Construction Technologies
Davco
Flexco NZ
Mapei NZ
Technokolla (Protective Surfaces)
Waterproofing Systems

CEMENTITIOUS MEMBRANES

Sikalastic-152
Superflex WPM002
DampFix 3
Liquid Flash 2
AquaBlok 2
Dampfast
Miracryl
Mapelastick Smart
Rasolastik
Gripset 2P

ACRYLIC / URETHANE MEMBRANES

Sikalastic-220W
WPM155 Rapid
DampFix Gold
Hydrathane
AquaBlok W1
Dampflex
Flexi-Seal
Aquadefense
Rasogum
Gripset 38

NOTE

All on-site specifications and conditions are to comply with the respective waterproofing manufacturer's specifications and recommendations. Impresa Tile Showers Ltd. does not imply nor provide any warranties for any product listed herein.

NEXUS & URBIS SHOWER -- ALCOVE

'INLINE' GLASS ENCLOSURE INSTALLATION

IMPORTANT NOTE

NOTE: Ensure Hinge Panel is installed with the top hinge cut-out 250mm from top edge of panel. Bottom hinge cut-out is 270mm from bottom edge of panel.

With plumb walls, glass will sit approx. 10-15mm into channel.

Glass Hinge Panel is to be made plumb and made level with top of glazing channel. Internally, a continuous bead of clear silicone is to be applied between sidelite and channel. Glass panel is to be pushed hard against channel and excess silicone removed. Externally, silicone is to be applied between glass and glazing channel and excess silicone removed. Ensure the installed panel is flush with the end of the tray glazing channel.

Clear silicone applied into each tray / wall channel butt-joint immediately prior to installation of each sidelite.

Apply silicone to open end of channel / bottom of glass sidelite to prevent water ingress into channel.

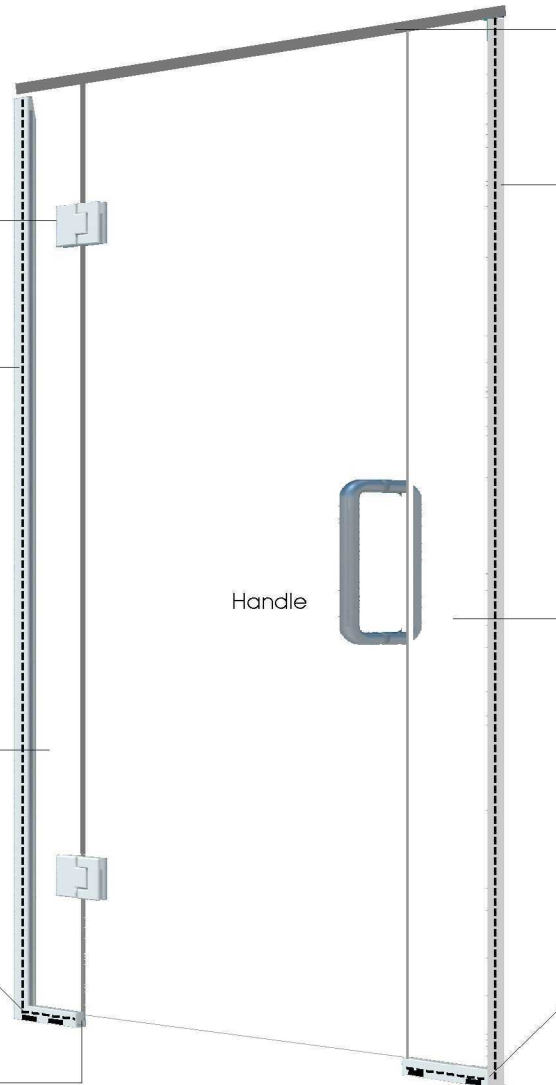

Aluminium Brace Bar secured with silicone adhesive or Clamp Brackets.

IMPORTANT NOTE

WALL GLAZING CHANNELS

Wall channels are to be adhered directly to the waterproofed walls with the supplied silicone BEFORE the application of wall tile.

Apply a continuous bead of silicone to entire length of back side of channel. Adhere channel to wall and apply a continuous beads of silicone to inside and outside of channel / wallboard junction

Glass Side Panel is to be made plumb and made level with top of glazing channel. On the shower interior, apply a continuous bead of clear silicone between the side panel and the glazing channel. Push the glass panel hard against the tray and wall channels, spray water, and remove excess silicone. Externally, apply silicone between the glass and glazing channel and remove excess silicone. Ensure the installed panel is flush with the end of the tray glazing channel.

9x10mm Setting Blocks supporting Hinge Panel. Utilise / adjust blocks to ensure glass is level or 1.5mm max. above top of channel.

NEXUS & URBIS SHOWER

CORNER GLASS ENCLOSURE INSTALLATION

IMPORTANT NOTE

WALL GLAZING CHANNELS

Wall channels are to be adhered directly to the waterproofed walls with the supplied silicone BEFORE the application of wall tile.

Glass Return panel is to be made plumb and level with top of glazing channel. Internally, a continuous bead of clear silicone is to be applied between glass and glazing channel. Return is to be pushed hard against channel and excess silicone removed. Externally, silicone is to be applied between glass and glazing channel and excess silicone removed.

With plumb walls, glass will sit approx. 10 - 15mm into channel.

A continuous bead of clear silicone to be applied to return panel edge. Ensuring the Side Panel will be level with the Return Panel and wall channel, insert the Side Panel into tray channel and adhere the panel to the return panel edge. Remove any excess silicone.

Clear silicone applied to each tray / wall channel butt-joint immediately prior to installation of sidelite or return panel.

Clear silicone to bottom of sidelites to seal-off end of channels.

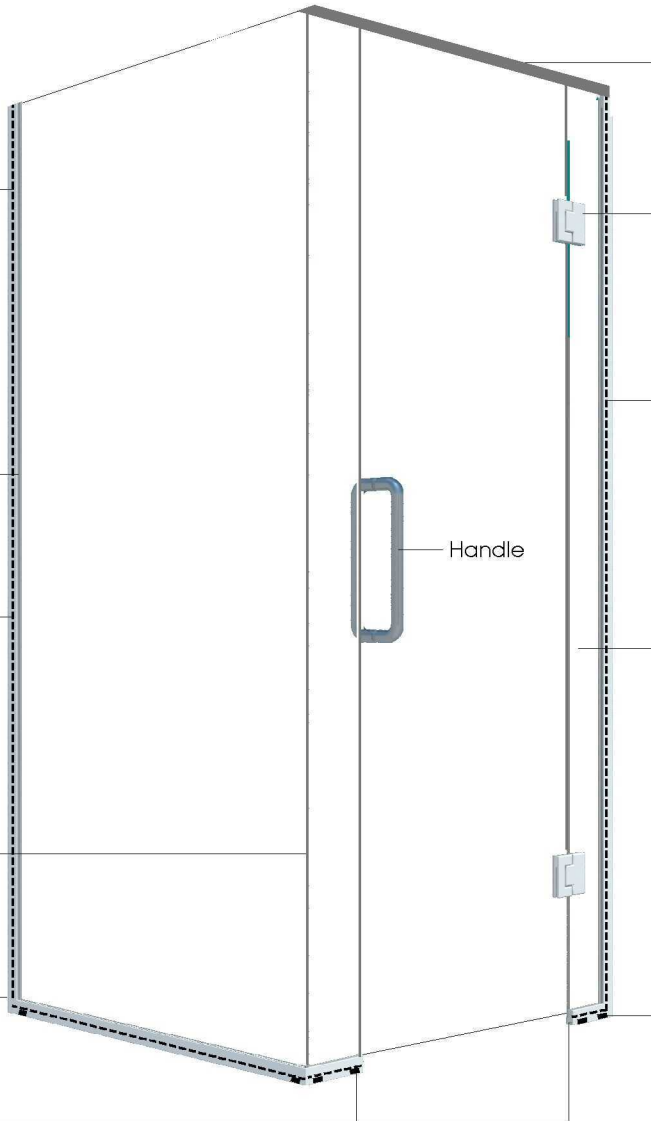

Aluminium Brace Bar secured with silicone adhesive or Clamp Brackets.

NOTE: Ensure Hinge Panel is installed with the top hinge cut-out 250mm from top edge of panel. Bottom hinge cut-out is 270mm from bottom edge of panel.

Glazing channel adhered to waterproofed wallboard with continuous bead of silicone applied to entire length of back side of channel and each channel / wallboard junction.

Glass Side Panel is to be made plumb and made level with top of glazing channel. On the shower interior, apply a continuous bead of clear silicone between the side panel and the glazing channel. Push the glass panel hard against the tray and wall channels, spray water, and remove excess silicone. Externally, apply silicone between the glass and glazing channel and remove excess silicone. Ensure the installed panel is flush with the end of the tray glazing channel.

9 x 10mm Setting Blocks supporting Hinge Panel. Utilise / adjust blocks to ensure glass is level or 1.5mm max. above top of channel.