

STEP 1

FRAMING / NOG INSTALLATION

Determine the position of the niche according to the preferred height / tile set-out. Select a niche that fits between the studs. Install a nog above and below where the niche will be positioned, ensuring the nogs are spaced at a dimension 5mm greater than the 'box' portion of the niche. Affix a nog to each side of the studs to provide wallboard fixing (see drawing).

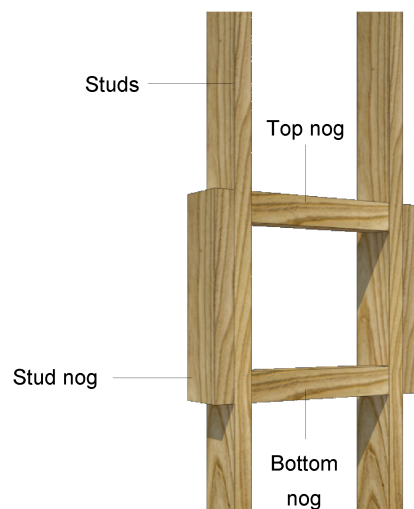

STEP 2

NICHE ADHESIVE APPLICATION

Apply 15mm thick 'daubs' of supplied silicone adhesive to each corner and centre of the backside of the niche perimeter flanges, and two daubs to the bottom of the niche. See image below.

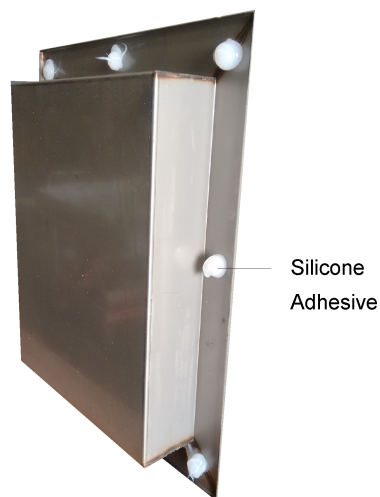

STEP 3

ADHERING NICHE TO FRAMING

With silicone adhesive applied to the niche, place the niche onto the bottom nog and insert the niche into the framed / nogged cavity, ensuring the niche perimeter flanges make contact with the studs and horizontal nogs. (The front face of the niche will finish approx. 8mm off the framing)

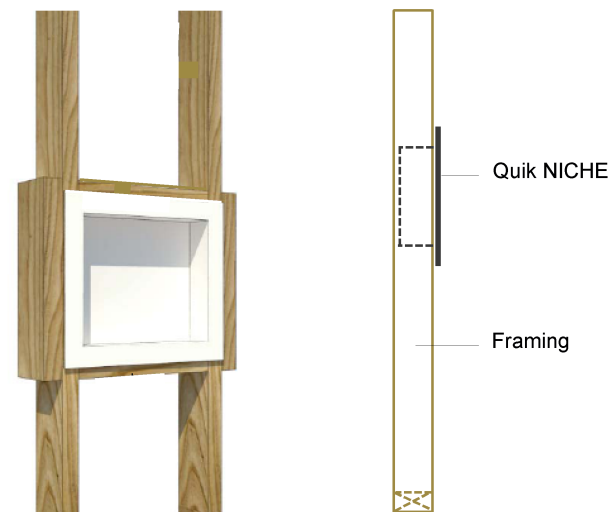

STEP 4

AFFIXING WALLBOARD TO FRAMING

Cut wallboard (plasterboard or fibre-cement board) a few millimetres larger than the niche and affix the wallboard to the framing as per the manufacturer's instructions.

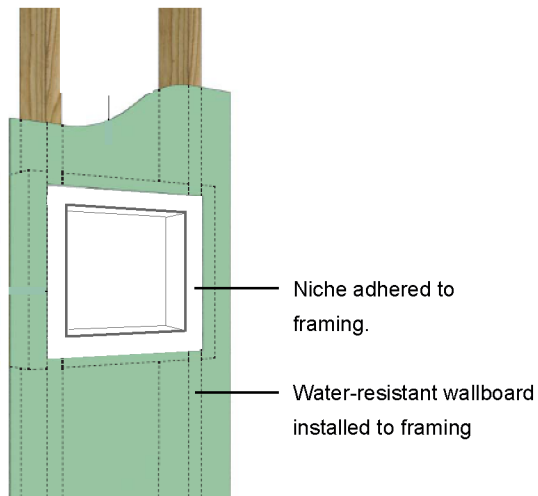

STEP 5

'PEEL AND STICK' MEMBRANE APPLICATION

Peel the backing paper from the membrane sheet and apply the membrane to the face of the niche. From the pre-cut top left-hand corner, cut the membrane down the LH side to the bottom of the niche internal edge. Repeat the procedure to the right-hand side of the niche. Cut the membrane along the bottom of the niche internal edge. Holding the membrane, cut the top edge of the membrane and apply the separated membrane sheet to the internal back surface of the niche.

Finally, apply the pre-cut 80mm-wide strip / roll of membrane to the internal sides of the niche.

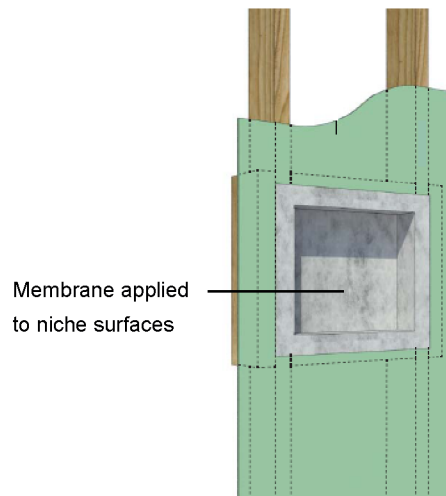

STEP 6

LIQUID WATERPROOFING APPLICATION

Waterproofer / tiler is to apply a 'bandage' connection tape to the wallboard / niche perimeter flange joint. Brush / roll 'liquid-applied' waterproofing to the wallboard and entire niche as per the manufacturer's instructions.

Tile is to be installed with the tile adhesive recommended by the waterproofing manufacturer. The tiled edges around the niche can be mitred or 'trimmed' / capped with an aluminium tile trim.

